

WALLACE MORRIS KLINE SURVEYING, LLC
Land Survey Consulting

APN: 124-21-520-002

EXHIBIT "A"

EXPLANATION: THIS DESCRIPTION REPRESENTS THE VACATION OF A PUBLIC UTILITY EASEMENT IN SUPPORT OF THE "PARK HIGHLANDS SOUTHWEST" PROJECT.

DESCRIPTION

THAT PORTION OF THE PUBLIC UTILITY EASEMENT RECORDED JANUARY 4, 2022, IN BOOK 20220104 OF OFFICIAL RECORDS, AS INSTRUMENT NO. 00209, BEING A PORTION OF LOT 2 OF "PARK HIGHLANDS SOUTHWEST" AS SHOWN BY MAP THEREOF IN BOOK 170, PAGE 54 OF PLATS IN THE CLARK COUNTY RECORDER'S OFFICE, NEVADA, LYING WITHIN THE NORTHEAST QUARTER (NE1/4) OF SECTION 21, TOWNSHIP 19 SOUTH, RANGE 61 EAST, M.D.M., CITY OF NORTH LAS VEGAS, CLARK COUNTY, NEVADA, DESCRIBED AS FOLLOWS:

COMMENCING AT THE NORTHEAST CORNER OF SAID SECTION 21;

THENCE ALONG THE EASTERLY LINE OF SAID SECTION 21, SOUTH 00°00'34" WEST, 701.29 FEET;

THENCE DEPARTING THE EASTERLY LINE OF SAID SECTION 21, SOUTH 90°00'00" WEST, 302.72 FEET TO THE **POINT OF BEGINNING**, ALSO BEING A POINT ON THE NORTHERLY LINE OF SAID LOT 2;

THENCE DEPARTING THE NORTHERLY LINE OF SAID LOT 2, SOUTH 00°00'00" WEST, 11.00 FEET;

THENCE SOUTH 90°00'00" WEST, 20.00 FEET;

THENCE NORTH 00°00'00" EAST, 11.00 FEET TO A POINT ON THE NORTHERLY LINE OF SAID LOT 2;

THENCE ALONG THE NORTHERLY LINE OF SAID LOT 2, NORTH 90°00'00" EAST, 20.00 FEET TO THE **POINT OF BEGINNING**.

CONTAINING 220 SQUARE FEET, MORE OR LESS.

BASIS OF BEARINGS

SOUTH 00°00'34" WEST, BEING THE BEARING OF THE EAST LINE OF THE NORTHEAST QUARTER (NE1/4) OF THE NORTHEAST QUARTER (NE1/4) OF SAID SECTION 21, TOWNSHIP 19 SOUTH, RANGE 61 EAST, M.D.M., CITY OF NORTH LAS VEGAS, CLARK COUNTY, NEVADA, AS SHOWN BY MAP THEREOF IN BOOK 170, PAGE 54 OF PLATS IN THE CLARK COUNTY RECORDER'S OFFICE, NEVADA.

JASON G. KLINE, PLS
NEVADA LICENSE NO. 17827

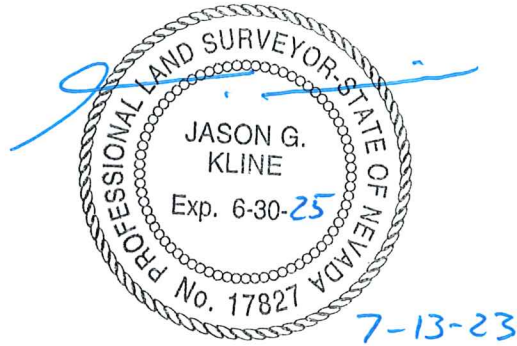

APN: 124-21-520-002

VACATION OF PUBLIC UTILITY EASEMENT — OR:20220104:00209

LINE	BEARING	DISTANCE
L1	S00°00'00"W	11.00'
L2	S90°00'00"W	20.00'
L3	N00°00'00"E	11.00'
L4	N90°00'00"E	20.00'

LOT 1
PARK HIGHLANDS SOUTHWEST
BOOK 170, PAGE 54
OF PLATS

POINT OF
COMMENCEMENT

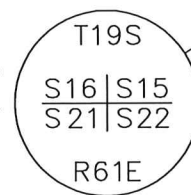

REVERE STREET

PUBLIC STREET DEDICATED PER
BOOK 140, PAGE 60 OF PLATS

701.29'

S00°00'34"W 1342.68'

BASIS OF BEARINGS

PER BOOK 170, PAGE 54 OF PLATS

NELSON BAY AVENUE
BOOK 167, PAGE 29 OF PLATS
CROSS ACCESS EASEMENT GRANTED
PER FILE 127, PAGE 41 OF PARCEL MAPS
TO BE PRIVATELY MAINTAINED

S90°00'00"W 302.72'

LOT 2
PARK HIGHLANDS SOUTHWEST
BOOK 170, PAGE 54 OF PLATS

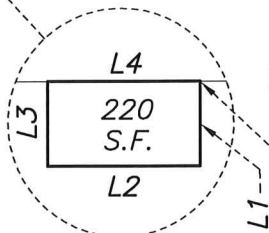

POINT OF
BEGINNING

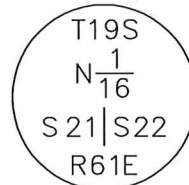

641.39'

P:\INS\21277 FULLERTON COVE OFFSITES\DWG\EXHIBITS\21277-VAC-02.DWG

WALLACE MORRIS KLINE
SURVEYING, LLC.
LAND SURVEY CONSULTING

6525 W. WARM SPRINGS RD.
#100, LAS VEGAS, NV 89118

EXHIBIT "B"

LYING WITHIN THE NORTHEAST QUARTER (NE1/4)
OF SECTION 21, T. 19 S., R. 61 E., M.D.M., CITY
OF NORTH LAS VEGAS, CLARK COUNTY, NEVADA

PAGE 1 OF 1