

PROJECT TEAM

OWNER
COLUMBIA NEVADA CAREY INDUSTRIAL, LLC
ATTN: JACOB EMERY
102 N. LASALLE STREET, SUITE 200
CHICAGO, IL 60602
PHONE: 312-345-8752
JEMERY@CIPC.COM

DEVELOPER
LINCOLN PROPERTY COMPANY
ATTN: MICHAEL MONROE
3131 EAST CAMELBACK ROAD, SUITE 318
PHOENIX, AZ 85016
PHONE: 602-912-8871
MMONROE@LPC.COM

CIVIL ENGINEER
ACTUS
3383 E. WARM SPRINGS ROAD, SUITE 300
LAS VEGAS, NEVADA 89119
T: 702-595-6208
ATTN: DARYL LATTIMORE, P.E.
DARYL.LATTIMORE@ACTUS-NV.COM

UTILITY CONTACTS

POWER
NV ENERGY
ATTN: NEW DEVELOPMENT
7155 LINDELL ROAD
LAS VEGAS, NEVADA 89119

WATER
CITY OF NORTH LAS VEGAS
ATTN: UTILITIES DEPARTMENT
2200 LAS VEGAS BOULEVARD
NORTH LAS VEGAS, NV 89030
T: 702-633-1484

SEWER
CITY OF NORTH LAS VEGAS
ATTN: UTILITIES DEPARTMENT
2200 LAS VEGAS BOULEVARD
NORTH LAS VEGAS, NV 89030
T: 702-633-1484

GAS
SOUTHWEST GAS CORPORATION
ATTN: ENGINEERING SERVICES
6565 STATE STREET
NORTH LAS VEGAS, NV 89115

TELEPHONE
CENTURY LINK
6702 VIA AUSTIN PARKWAY
LAS VEGAS, NEVADA 89119

DISPOSAL
REPUBLIC SERVICES, INC.
771 E. SAHARA AVE. P.O. BOX 98508
LAS VEGAS, NEVADA 89193-8508

CABLE
COX COMMUNICATIONS
1700 VEGAS DRIVE
LAS VEGAS, NEVADA 89106

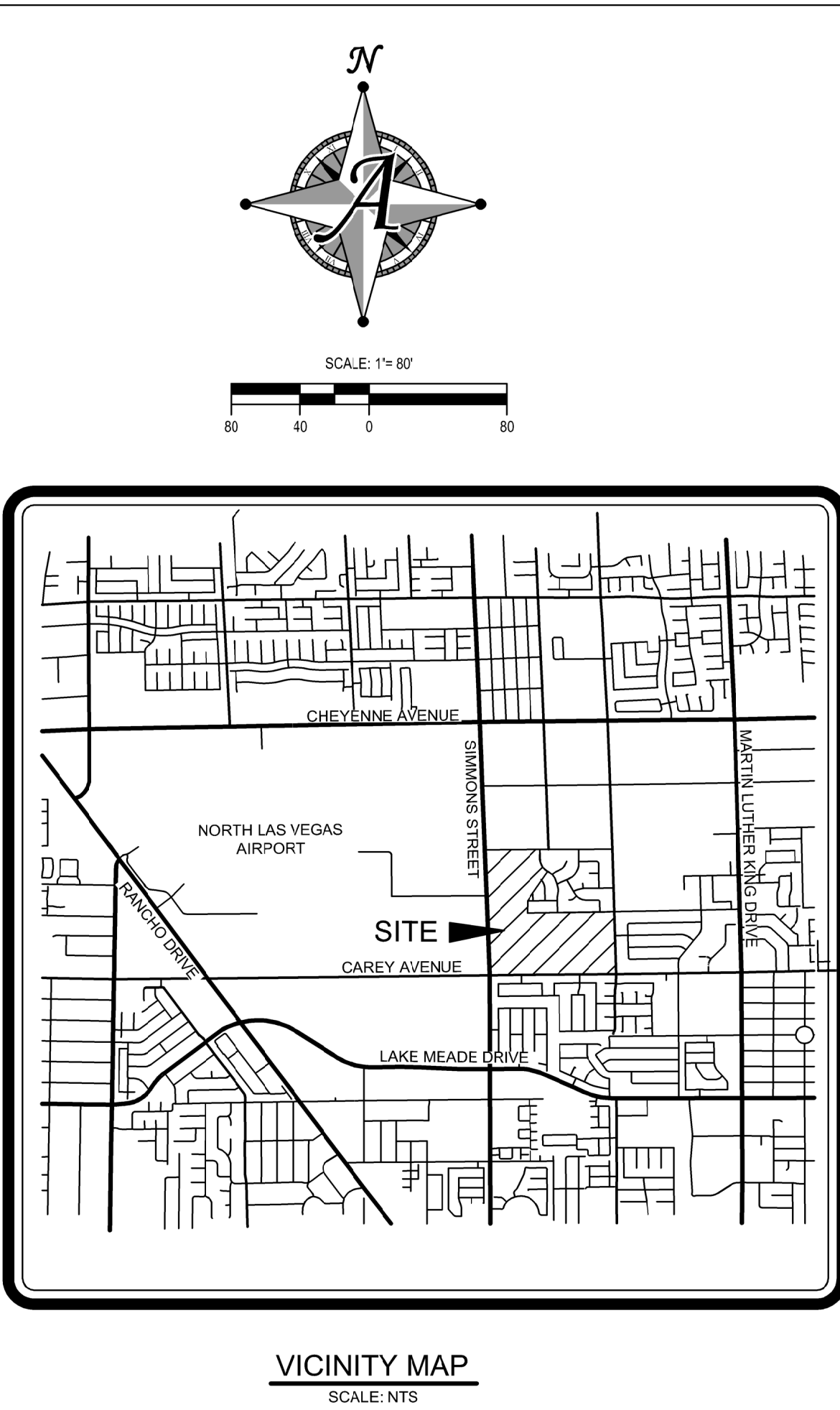

BASIS OF BEARINGS

SOUTH 02°11'43"EAST, BEING THE BEARING OF THE WEST LINE OF THE SOUTHWEST QUARTER (SW 1/4) OF THE SOUTHEAST QUARTER (SE 1/4) OF SECTION 17, TOWNSHIP 20 SOUTH, RANGE 61 EAST, M.D.M., CITY OF NORTH LAS VEGAS, CLARK COUNTY, NEVADA AS RECORDED IN FILE 63, PAGE 48 OF PLATS IN THE OFFICE OF THE CLARK COUNTY RECORDERS.

BENCHMARK

CITY OF NORTH LAS VEGAS BENCHMARK NO. NLV011704
A RIVET AND 2" ROUND ALUMINUM DISK SET IN THE TOP OF CURB,
LOCATED APPROX. 70 FEET NORTH OF THE NORTHWEST CORNER AT THE
INTERSECTION OF EVANS AND SIMMONS.
ELEVATION: 2152.81 (FEET)
655.17 (METERS)
BASED ON NORTH AMERICAN VERTICAL DATUM OF 1988 (NAVD88).

Call before you Dig
Underground
1-702-432-5300

Call before you Dig
Overhead
1-800-642-2444

Call before you Dig
Power Lines
1-702-227-2929

DISCLAIMER NOTE
THE UNDERGROUND UTILITIES AS SHOWN HEREON HAVE BEEN LOCATED FROM OBSERVED FIELD SURVEY EVIDENCE AND EXISTING DRAWINGS, INCLUDING BUT NOT LIMITED TO THE FOLLOWING: PLANS PROVIDED BY THE CLIENT, UTILITY COMPANIES, AND MUNICIPAL AGENCIES. THE SURVEYOR MAKES NO GUARANTEES THAT THE UNDERGROUND UTILITIES SHOWN COMPRISE ALL SUCH UTILITIES IN THE AREA, EITHER IN SERVICE OR ABANDONED. THE SURVEYOR FURTHER DOES NOT WARRANT THAT THE UNDERGROUND UTILITIES SHOWN ARE IN THE EXACT LOCATION INDICATED ALTHOUGH HE DOES CERTIFY THAT THEY ARE PHYSICALLY LOCATED THE UNDERGROUND UTILITIES.

3383 E. Warm Springs Rd., Suite 300
Las Vegas, NV 89119
www.actus-nv.com
(702) 595-6208
Engineering • Surveying • Consulting • Planning

SITE PLAN

DATE	DESCRIPTION	BY

DATE: 03-30-2023
DRAWN: DL2
DESIGNED: DL2
CHECKED: DL2
PROJECT #: LP012101
SHEET GROUP:
SHEET NUMBER:
1
SHEET 1 OF 1

WINDSOR COMMERCE PARK
LINCOLN PRPERTY COMPANY
CITY OF NORTH LAS VEGAS