

**NORTH LAS VEGAS CITY COUNCIL
AGENDA ITEM**

Number: **20**

SUBJECT:

Award of the Centennial Parkway Channel East Project, Bid No. 1304.

REQUESTED BY:

Dr. Qiong Liu, P.E., P.T.O.E., Director of Public Works/City Engineer

RECOMMENDATION OR RECOMMENDED MOTION:

That the City Council accept the submitted bids and authorize the execution of the construction contract for the Centennial Parkway Channel East Project to the lowest responsive and responsible bidder, Eagle View Contractors, Inc. in a form approved by the City Attorney's Office.

FISCAL IMPACT:

Amount: \$18,507,593.90 Explanation: Regional Flood Control District (District)

ACCOUNT NUMBER:

450-290296-450540

STAFF COMMENTS AND BACKGROUND INFORMATION:

On April 16, 2008, the City Council approved an Interlocal Contract with the District, in the amount of \$23,727,813.00, for construction and construction management for the Centennial Parkway Channel East Project.

The Centennial Parkway Channel East Project consists of a storm drain system with all associated appurtenances to complete the Centennial Parkway Channel from 500 feet west of Revere Street to just east of Lawrence Street. The channel will tie into the existing Upper Las Vegas Wash Channel as shown on the attached Vicinity Map.

This Project consists of installing Reinforced Concrete Box Culverts along Centennial Parkway, ranging in size from 8 by 6 feet to double barrel 20 by 6 feet, and reinforced concrete pipe ranging from 18 to 66 inches in diameter. Confluence structures, storm drain inlets, and laterals will also be installed at strategic locations to collect surface flows. The majority of the facilities will be buried, and the existing landscaping will be restored and there will be approximately 500 feet of open channel at the western portion of this project.

Eight bids were received at a Public Bid Opening held on April 3, 2008. The lowest responsive Base Bid of \$18,507,593.90, submitted by Eagle View Contractors, Inc., is 12% below the consultant engineer's cost estimate, as shown on the attached bid abstract.

(Continued on Page 2)

LIST CITY COUNCIL GOAL(S):

This Flood Control Improvement Project is consistent with Council's Priorities of Well-Planned Quality Growth and a Safe and Livable Community.

PREPARED BY:

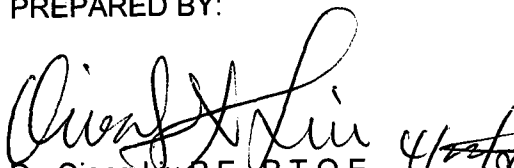
Dr. Qiong Liu P.E., P.T.O.E.
Director of Public Works/City Engineer

**RESPECTFULLY
SUBMITTED:**

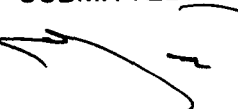
Gregory E. Rose
City Manager

**CITY COUNCIL
MEETING DATE:**

05/07/08

Eagle View Contractors, Inc. submitted a responsive bid proposal and is properly licensed and qualified to perform the work. The Project is required to be completed within 365 days following issuance of the Notice-to-Proceed.

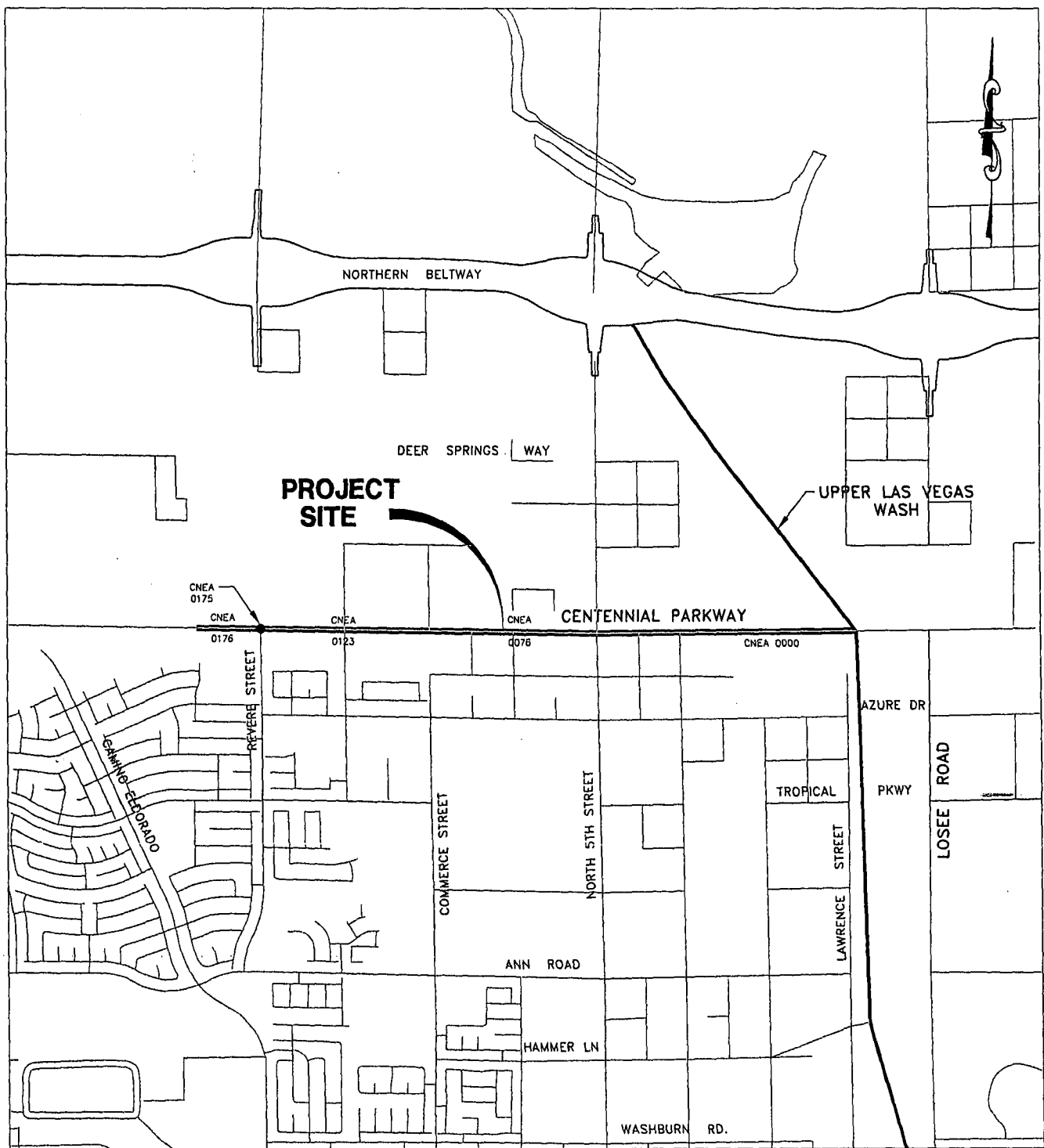

VICINITY MAP



**DEPARTMENT OF PUBLIC WORKS
ENGINEERING SERVICES DIVISION**

CENTENNIAL PARKWAY CHANNEL EAST PROJECT

SCALE: NONE

DRAWING NAME: 10081-VIC.Dwg

DRAWN BY: B. PARRAS

DATE: 01-31-07

SHEET NUMBER 1 OF 1

CITY OF NORTH LAS VEGAS
CONSTRUCTION CONTRACT

BID NO: 1304

DATE: _____

NAME OF CONTRACTOR: Eagle View Contractors, Inc.

ADDRESS OF CONTRACTOR: P.O. Box 397, Moapa, NV 89025

 Individual Partnership X Corporation

in the State of Nevada

Contract for CENTENNIAL PARKWAY CHANNEL EAST in the

amount of Eighteen Million Five Hundred Seven Thousand Five Hundred Ninety Three Dollars and Ninety Cents (\$18,507,593.90).

THIS CONTRACT entered into, effective this date by the City of North Las Vegas, Nevada, hereinafter called CITY, represented by the Mayor, executing this Contract, and the individual, partnership, or corporation named above, hereinafter called CONTRACTOR, witnesseth that the parties hereto do mutually agree as follows:

STATEMENT OF WORK: The CONTRACTOR shall furnish all labor, equipment and materials and perform the Work above described for the amount stated above in strict accordance with the Contract Documents, including the Specifications of the CITY and the schedule of Drawings and other requirements, all of which are incorporated herein by reference. All Work is the sole responsibility of the CONTRACTOR unless specifically provided otherwise.

TIME FOR COMPLETION: The Work which the CONTRACTOR is required to perform under this Contract shall be commenced at a time stipulated by the CITY in the written "Notice-to-Proceed" and shall be completed according to the following:

365 Consecutive Calendar Days to construction completion of the project, including completion of punch list items, final cleanup and demobilization

LIQUIDATED DAMAGES: Liquidated Damages as provided for in the specifications and conditions shall be assessed in the amounts stated below per day for each calendar day after the construction completion date, or applicable extension thereof as provided in the Specifications and Requirements, that completion of the Work is delayed.

- 1) Liquidated Damages for failure to complete the requirements for the Construction Completion milestone within the time period indicated shall be TWO THOUSAND DOLLARS (\$2,000) per day.
- 2) Liquidated Damages for late contract documents noted in the Contract Award Instructions Section, CI.14 shall be TWO HUNDRED DOLLARS (\$200) per day.

- 3) Liquidated Damages for late submittals noted in the Contract Award Instructions Section, CI.15 shall be FIVE HUNDRED DOLLARS (\$500) per day.
- 4) Liquidated Damages for failure to maintain traffic control devices as required in the Special Provisions shall be ONE THOUSAND DOLLARS (\$1,000) per hour.

IN WITNESS WHEREOF, the parties hereto have executed this Contract as of the date entered on the first page hereof.

CITY OF NORTH LAS VEGAS

CONTRACTOR

By _____
Michael L. Montandon
Mayor

By _____

Title

ATTEST:

Karen Storms, CMC
City Clerk

APPROVED AS TO FORM:

Carie Torrence
City Attorney

CITY OF NORTH LAS VEGAS

PERFORMANCE BOND

BOND NUMBER _____
DATE EXECUTED _____

IMPORTANT: SURETY COMPANIES EXECUTING BONDS MUST BE LICENSED TO ISSUE SURETY BY THE STATE OF NEVADA INSURANCE DIVISION PURSUANT TO NRS 683A.090 AND ISSUED BY AN APPOINTED AGENT PURSUANT TO NRS 683A.280. NOTE: INDIVIDUAL SURETY BONDS ARE NOT ACCEPTABLE.

KNOW ALL MEN BY THESE PRESENTS, That we, the CONTRACTOR AND SURETY, are held and firmly bound unto the City of North Las Vegas, Nevada, hereinafter referred to as the City, in the penal sum of _____
for the payment of which sum well and truly to be made, we bind ourselves, our heirs, executors, administrators, successors, and assigns, jointly and severally, firmly by these presents.

THE CONDITION OF THIS OBLIGATION IS SUCH, That whereas the CONTRACTOR entered into a certain Contract with the City, to perform all Work required under the Bidding Schedule(s), Bid No. 1304, of the City's specifications, entitled CENTENNIAL PARKWAY CHANNEL EAST.

NOW THEREFORE, if said CONTRACTOR shall well and truly perform and fulfill all the undertakings, covenants, terms and conditions and agreements of said Contract during the original term of said Contract, then this obligation shall be null and void, otherwise it shall remain in full force and effect.

PROVIDED, that any modifications in the Work to be done or the materials to be furnished, which may be made pursuant to the terms of said Contract, shall not in any way release either said Contractor or said Surety thereunder, nor shall any extensions of time granted under the provisions of said Contract release either said Contractor or said Surety, and notice of such modifications or extensions of the Contract is hereby waived by said Surety.

SIGNED this _____ day of _____, 200_____.

(SEAL AND NOTARIAL ACKNOWLEDGMENT
OF SURETY)

(Resident Agent)

(Principal Contractor)

(State of Nevada, License Number)

(Authorized Representative and Title)

(Appointed Agent Name)

By: _____
(Signature)

Surety: _____

By: _____
(Signature)

(State of Nevada, License Number)

Address: _____

(Appointed Agent Name)

Telephone: _____

By: _____
(Signature)

Address: _____

Telephone: _____

ISSUING COMPANY MUST HOLD CERTIFICATES OF AUTHORITY AS ACCEPTABLE SURETY ON FEDERAL BONDS AND AS ACCEPTABLE REINSURING COMPANY WITH LISTING IN THE DEPARTMENT OF TREASURY, FISCAL SERVICE, (DEPARTMENT CIRCULAR 570, CURRENT REVISION) AND AS LISTED WITH A. M. BEST COMPANY WITH A RATING OF A OR BETTER.

CITY OF NORTH LAS VEGAS
LABOR AND MATERIAL PAYMENT BOND

BOND NUMBER _____
DATE EXECUTED _____

IMPORTANT: SURETY COMPANIES EXECUTING BONDS MUST BE LICENSED TO ISSUE SURETY BY THE STATE OF NEVADA INSURANCE DIVISION PURSUANT TO NRS 683A.090 AND ISSUED BY AN APPOINTED AGENT PURSUANT TO NRS 683A.280. NOTE: INDIVIDUAL SURETY BONDS ARE NOT ACCEPTABLE.

KNOW ALL MEN BY THESE PRESENTS, That we, the CONTRACTOR AND SURETY, are held and firmly bound unto the City of North Las Vegas, Nevada, hereinafter referred to as the City, in the penal sum of _____ for the payment of which sum well and truly to be made, we bind ourselves, our heirs, executors, administrators, successors, and assigns, jointly and severally, firmly by these presents.

THE CONDITION OF THIS OBLIGATION IS SUCH, That whereas the CONTRACTOR entered into a certain Contract with the City, to perform all Work required under the Bidding Schedule(s), Bid No. 1304, of the City's specifications, entitled CENTENNIAL PARKWAY CHANNEL EAST.

NOW THEREFORE, if said CONTRACTOR, fails to pay for any materials, equipment, or other supplies, or for rental of same, used in connection with the performance of Work contracted to be done, or for amounts due under applicable State Law for any work or labor thereon, said Surety will pay for the same in an amount not exceeding the sum specified above and in the event suit is brought upon this bond, a reasonable attorney's fee to be fixed by the court. This bond shall insure to the benefit of any persons, companies or corporations entitled to file claims under applicable State Law. This bond shall remain in effect until two (2) years after the date of final acceptance of the Work by the City Council.

PROVIDED, that any modifications in the Work to be done or the materials to be furnished, which may be made pursuant to the terms of said Contract, shall not in any way release either said Contractor or said Surety thereunder, nor shall any extensions of time granted under the provisions of said Contract release either said Contractor or said Surety, and notice of such modifications or extensions of the Contract is hereby waived by said Surety.

SIGNED this _____ day of _____, 200_____.

(SEAL AND NOTARIAL ACKNOWLEDGMENT
OF SURETY)

(Resident Agent)

(Principal Contractor)

(State of Nevada, License Number)

(Authorized Representative and Title)

(Appointed Agent Name)

By: _____
(Signature)

Surety: _____

By: _____
(Signature)

(State of Nevada, License Number)

Address: _____

(Appointed Agent Name)

Telephone: _____

By: _____
(Signature)

Address: _____

Telephone: _____

ISSUING COMPANY MUST HOLD CERTIFICATES OF AUTHORITY AS ACCEPTABLE SURETY ON FEDERAL BONDS AND AS ACCEPTABLE REINSURING COMPANY WITH LISTING IN THE DEPARTMENT OF TREASURY, FISCAL SERVICE, (DEPARTMENT CIRCULAR 570, CURRENT REVISION) AND AS LISTED WITH A. M. BEST COMPANY WITH A RATING OF A OR BETTER.

CITY OF NORTH LAS VEGAS

GUARANTEE BOND

BOND NUMBER _____
DATE EXECUTED _____

IMPORTANT: SURETY COMPANIES EXECUTING BONDS MUST BE LICENSED TO ISSUE SURETY BY THE STATE OF NEVADA INSURANCE DIVISION PURSUANT TO NRS 683A.090 AND ISSUED BY AN APPOINTED AGENT PURSUANT TO NRS 683A.280. NOTE: INDIVIDUAL SURETY BONDS ARE NOT ACCEPTABLE.

GUARANTEE for

(Name and Address of Prime Contractor)
We hereby guarantee that the _____ CENTENNIAL PARKWAY CHANNEL EAST _____ which we have constructed, has been completed in accordance with the Contract Documents, and that the Work as constructed will fulfill the requirements of the guaranties included in the Contract Documents. We agree to repair or replace any or all of the Work together with any other adjacent Work which may be damaged in so doing, that may prove to be defective in workmanship or materials within a period of one year from the date of final acceptance of the above-named Work by the City of North Las Vegas, State of Nevada, without expense whatsoever to the City of North Las Vegas, ordinary wear and unusual abuse or neglect are exempted.

In the event of our failure to comply with the above-mentioned conditions within five (5) days after being notified in writing by the City of North Las Vegas, Nevada, we collectively or separately do hereby authorize the City of North Las Vegas to proceed to have said defects repaired and made good at our expense and we will honor and pay the costs and charges therefore upon demand.

Date of Completion _____

SIGNED this _____ day of _____, 200____.

(SEAL AND NOTARIAL ACKNOWLEDGMENT
OF SURETY)

(Resident Agent)

(Principal Contractor)

(State of Nevada, License Number)

(Authorized Representative and Title)

(Appointed Agent Name)

By: _____
(Signature)

Surety: _____

By: _____
(Signature)

(State of Nevada, License Number)

Address: _____

(Appointed Agent Name)

Telephone: _____

By: _____
(Signature)

Address: _____

Telephone: _____

ISSUING COMPANY MUST HOLD CERTIFICATES OF AUTHORITY AS ACCEPTABLE SURETY ON FEDERAL BONDS AND AS ACCEPTABLE REINSURING COMPANY WITH LISTING IN THE DEPARTMENT OF TREASURY, FISCAL SERVICE, (DEPARTMENT CIRCULAR 570, CURRENT REVISION) AND AS LISTED WITH A. M. BEST COMPANY WITH A RATING OF A OR BETTER.

BID ABSTRACT
CITY OF NORTH LAS VEGAS
CENTENNIAL PARKWAY CHANNEL EAST
BID NO. 1304 - LABOR COMMISSION NO. PWP CL-2008-188
BID DATE: April 3, 2008

ITEM	DESCRIPTION	QTY	UNIT	ENGINEER'S ESTIMATE		EAGLE VIEW CONTRACTORS		FREHNEER CONSTRUCTION CO. INC.		RAFAEL CONSTRUCTION, INC.		MEADOW VALLEY CONTRACTORS, INC.		
				UNIT PRICE	TOTAL PRICE	UNIT PRICE	TOTAL PRICE	UNIT PRICE	TOTAL PRICE	UNIT PRICE	TOTAL PRICE	UNIT PRICE	TOTAL PRICE	
107.01	Traffic Control	1	LS	\$ 90,000.00	\$ 90,000.00	\$ 81,371.00	\$ 81,371.00	\$ 245,600.00	\$ 245,600.00	\$ 125,000.00	\$ 125,000.00	\$ -	\$ -	B
108.01	Partnering Workshop	1	LS	\$ 7,500.00	\$ 7,500.00	\$ 7,500.00	\$ 7,500.00	\$ 7,500.00	\$ 7,500.00	\$ 7,500.00	\$ 7,500.00	\$ 7,500.00	\$ 7,500.00	
109.01	Construction Conflict	1	LS	\$ 750,000.00	\$ 750,000.00	\$ 750,000.00	\$ 750,000.00	\$ 750,000.00	\$ 750,000.00	\$ 750,000.00	\$ 750,000.00	\$ 750,000.00	\$ 750,000.00	
200.01	Mobilization	1	LS	\$ 1,000,000.00	\$ 1,000,000.00	\$ 1,299,070.00	\$ 1,299,070.00	\$ 1,443,898.00	\$ 1,443,898.00	\$ 857,601.00	\$ 857,601.00	\$ 1,360,000.00	\$ 1,360,000.00	
201.01	Clearing and Grubbing	1	LS	\$ 20,000.00	\$ 20,000.00	\$ 257,657.00	\$ 257,657.00	\$ 11,810.00	\$ 11,810.00	\$ 75,000.00	\$ 75,000.00	\$ 3,900.00	\$ 3,900.00	
202.01	Remove Headwall at Sta. 36+10	1	LS	\$ 5,000.00	\$ 5,000.00	\$ 8,656.00	\$ 8,656.00	\$ 2,800.00	\$ 2,800.00	\$ 4,000.00	\$ 4,000.00	\$ 6,010.00	\$ 6,010.00	
202.02	Remove Headwall (Wingwalls Only)	4	EA	\$ 3,000.00	\$ 12,000.00	\$ 4,034.00	\$ 16,136.00	\$ 1,200.00	\$ 4,800.00	\$ 6,000.00	\$ 24,000.00	\$ 6,010.00	\$ 24,040.00	
202.03	Remove Portion of 16-ft by 6-ft Reinforced Concrete Arch Culvert from Sta. 36+10 to Sta. 36+64	54	LF	\$ 150.00	\$ 8,100.00	\$ 649.00	\$ 35,046.00	\$ 260.00	\$ 14,040.00	\$ 300.00	\$ 16,200.00	\$ 121.00	\$ 6,534.00	
202.04	Remove Curb and Gutter	1,460	LF	\$ 5.00	\$ 7,300.00	\$ 5.80	\$ 8,468.00	\$ 2.00	\$ 2,920.00	\$ 5.00	\$ 7,300.00	\$ 2.60	\$ 3,796.00	
202.05	Remove Concrete Sidewalk	28,500	SF	\$ 2.00	\$ 57,000.00	\$ 1.10	\$ 31,350.00	\$ 1.00	\$ 28,500.00	\$ 1.50	\$ 42,750.00	\$ 0.85	\$ 24,225.00	
202.06	Remove AC Pavement Path	3,250	LF	\$ 4.00	\$ 13,000.00	\$ 4.91	\$ 15,957.50	\$ 1.50	\$ 4,875.00	\$ 2.50	\$ 8,125.00	\$ 3.00	\$ 9,750.00	
202.07	Remove AC Pavement	3,900	SY	\$ 5.00	\$ 19,500.00	\$ 4.09	\$ 15,951.00	\$ 8.50	\$ 33,150.00	\$ 7.00	\$ 27,300.00	\$ 7.30	\$ 28,470.00	
202.08	Remove Bubbler Structure at Sta. 49+12	1	LS	\$ 4,000.00	\$ 4,000.00	\$ 11,286.00	\$ 11,286.00	\$ 10,000.00	\$ 10,000.00	\$ 6,000.00	\$ 6,000.00	\$ 4,140.00	\$ 4,140.00	
202.09	Remove Grouted Riprap at Revere	208	CY	\$ 50.00	\$ 10,400.00	\$ 55.00	\$ 11,440.00	\$ 21.00	\$ 4,368.00	\$ 25.00	\$ 5,200.00	\$ 56.50	\$ 11,752.00	
202.10	Remove 6-inch Riprap from Sta. 103+60 to Sta. 109+42	2,250	CY	\$ 15.00	\$ 33,750.00	\$ 24.81	\$ 55,822.50	\$ 11.00	\$ 24,750.00	\$ 25.00	\$ 56,250.00	\$ 20.50	\$ 46,125.00	
202.11	Remove Concrete Channel Bottom from Sta. 103+60 to Sta. 116+00	1,500	SY	\$ 25.00	\$ 37,500.00	\$ 21.69	\$ 32,535.00	\$ 4.00	\$ 6,000.00	\$ 17.00	\$ 25,500.00	\$ 23.00	\$ 34,500.00	
202.12	Remove Wrought Iron Fence (Donna to Bruce)	1,332	LF	\$ 5.00	\$ 6,660.00	\$ 2.50	\$ 3,330.00	\$ 3.00	\$ 3,996.00	\$ 6.00	\$ 7,992.00	\$ 3.00	\$ 3,996.00	
202.13	Remove Retaining Wall	1	LS	\$ 12,000.00	\$ 12,000.00	\$ 50,100.00	\$ 50,100.00	\$ 9,900.00	\$ 9,900.00	\$ 20,000.00	\$ 20,000.00	\$ 13,500.00	\$ 13,500.00	
202.14	Remove and Reset Marquee Sign	1	LS	\$ 5,000.00	\$ 5,000.00	\$ 8,258.00	\$ 8,258.00	\$ 9,000.00	\$ 9,000.00	\$ 35,000.00	\$ 35,000.00	\$ 1,310.00	\$ 1,310.00	
203.01	Channel Excavation	120,000	CY	\$ 15.00	\$ 1,800,000.00	\$ 10.61	\$ 1,273,200.00	\$ 12.25	\$ 1,470,000.00	\$ 7.00	\$ 840,000.00	\$ 12.15	\$ 1,458,000.00	
203.02	Over-Excavation	12,000	CY	\$ 8.00	\$ 96,000.00	\$ 16.50	\$ 198,000.00	\$ 24.00	\$ 288,000.00	\$ 12.00	\$ 144,000.00	\$ 4.90	\$ 58,800.00	
208.01	Permanent Pavement Patch	820	TN	\$ 90.00	\$ 73,800.00	\$ 221.10	\$ 181,302.00	\$ 235.00	\$ 192,700.00	\$ 150.00	\$ 123,000.00	\$ 94.00	\$ 77,080.00	
212.01	Modify Landscaping and Irrigation System	1	LS	\$ 600,000.00	\$ 600,000.00	\$ 550,550.00	\$ 550,550.00	\$ 608,211.00	\$ 608,211.00	\$ 525,000.00	\$ 525,000.00	\$ 511,700.00	\$ 511,700.00	
302.01	Type II Access Road & Manway	401	TN	\$ 20.00	\$ 8,020.00	\$ 31.00	\$ 12,431.00	\$ 21.00	\$ 8,421.00	\$ 27.00	\$ 10,827.00	\$ 16.50	\$ 6,616.50	
502.01	Transition Structure from Sta. 27+63 to Sta. 30+00	1	LS	\$ 177,750.00	\$ 177,750.00	\$ 209,784.00	\$ 209,784.00	\$ 152,680.00	\$ 152,680.00	\$ 240,000.00	\$ 240,000.00	\$ 135,300.00	\$ 135,300.00	
502.02	Junction Structure at Revere Street from Sta. 36+26 to Sta. 36+64	1	LS	\$ 40,200.00	\$ 40,200.00	\$ 128,067.00	\$ 128,067.00	\$ 90,619.00	\$ 90,619.00	\$ 120,000.00	\$ 120,000.00	\$ 87,000.00	\$ 87,000.00	
502.03	Transition Structure from Sta. 49+11 to Sta. 49+74	1	LS	\$ 45,900.00	\$ 45,900.00	\$ 96,418.00	\$ 96,418.00	\$ 45,770.00	\$ 45,770.00	\$ 50,000.00	\$ 50,000.00	\$ 44,600.00	\$ 44,600.00	
502.04	Junction Structure from Sta. 63+52 to Sta. 63+70	1	LS	\$ 25,200.00	\$ 25,200.00	\$ 61,860.00	\$ 61,860.00	\$ 35,428.00	\$ 35,428.00	\$ 75,000.00	\$ 75,000.00	\$ 39,300.00	\$ 39,300.00	
502.05	Transition Structure from Sta. 63+70 to Sta. 63+88	1	LS	\$ 20,000.00	\$ 20,000.00	\$ 41,963.00	\$ 41,963.00	\$ 23,263.00	\$ 23,263.00	\$ 51,000.00	\$ 51,000.00	\$ 19,600.00	\$ 19,600.00	
502.06	Transition Structure from Sta. 80+98 to Sta. 81+08	1	LS	\$ 30,000.00	\$ 30,000.00	\$ 28,023.00	\$ 28,023.00	\$ 17,800.00	\$ 17,800.00	\$ 30,000.00	\$ 30,000.00	\$ 16,500.00	\$ 16,500.00	
502.07	Transition Structure from Sta. 90+77 to Sta. 90+93	1	LS	\$ 250,000.00	\$ 250,000.00	\$ 40,955.00	\$ 40,955.00	\$ 33,290.00	\$ 33,290.00	\$ 52,000.00	\$ 52,000.00	\$ 32,200.00	\$ 32,200.00	
502.08	Transition Structure from Sta. 91+79 to Sta. 92+79	1	LS	\$ 100,000.00	\$ 100,000.00	\$ 310,235.00	\$ 310,235.00	\$ 254,428.00	\$ 254,428.00	\$ 330,000.00	\$ 330,000.00	\$ 223,500.00	\$ 223,500.00	
502.09	Transition Structure from Sta. 126+19 to Sta. 126+44	1	LS	\$ 42,750.00	\$ 42,750.00	\$ 109,383.00	\$ 109,383.00	\$ 72,973.00	\$ 72,973.00	\$ 100,000.00	\$ 100,000.00	\$ 67,000.00	\$ 67,000.00	
502.10	15-ft by 6.5 ft Rectangular Concrete Channel from Sta. 30+00 to Sta. 35+53 including Transition	553	LF	\$ 435.00	\$ 240,555.00	\$ 547.00	\$ 302,491.00	\$ 495.00	\$ 273,735.00	\$ 550.00	\$ 304,150.00	\$ 509.00	\$ 281,477.00	
502.11	Headwall for 15-ft by 6-ft RCB (Revere St.)	1	LS	\$ 15,000.00	\$ 15,000.00	\$ 25,103.00	\$ 25,103.00	\$ 12,991.00	\$ 12,991.00	\$ 20,000.00	\$ 20,000.00	\$ 12,800.00	\$ 12,800.00	
502.12	Headwall for 15-ft by 6-ft RCB (Centennial St.)	1	LS	\$ 15,000.00	\$ 15,000.00	\$ 25,097.00	\$ 25,097.00	\$ 12,991.00	\$ 12,991.00	\$ 10,000.00	\$ 10,000.00	\$ 12,800.00	\$ 12,800.00	
502.13	Flow Equalization Structure	2	EA	\$ 15,000.00	\$ 30,000.00	\$ 15,706.00	\$ 31,412.00	\$ 20,387.00	\$ 40,774.00	\$ 50,000.00	\$ 100,000.00	\$ 26,700.00	\$ 53,400.00	
603.01	18-in RCP Storm Drain Class III	217	LF	\$ 100.00	\$ 21,700.00	\$ 152.00	\$ 32,984.00	\$ 200.00	\$ 43,400.00	\$ 240.00	\$ 52,080.00	\$ 130.00	\$ 28,210.00	
603.02	24-in RCP Storm Drain Class III	113	LF	\$ 125.00	\$ 14,125.00	\$ 228.00	\$ 25,764.00	\$ 200.00	\$ 22,600.00	\$ 325.00	\$ 36,725.00	\$ 164.00	\$ 18,532.00	
603.03	30-in RCP Storm Drain Class III	104	LF	\$ 150.00	\$ 15,600.00	\$ 260.00	\$ 27,040.00	\$ 340.00	\$ 35,360.00	\$ 300.00	\$ 31,200.00	\$ 146.00	\$ 15,184.00	
603.04	36-in RCP Storm Drain Class III	19	LF	\$ 175.00	\$ 3,325.00	\$ 369.00	\$ 7,011.00	\$ 440.00	\$ 8,360.00	\$ 400.00	\$ 7,600.00	\$ 197.00	\$ 3,743.00	
603.05	42-in RCP Storm Drain Class III	10	LF	\$ 190.00	\$ 1,900.00	\$ 678.00	\$ 6,780.00	\$ 460.00	\$ 4,600.00	\$ 660.00	\$ 6,600.00	\$ 336.00	\$ 3,360.00	
603.06	48-in RCP Storm Drain Class III	35	LF	\$ 200.00	\$ 7,000.00	\$ 335.00	\$ 11,725.00	\$ 260.00	\$ 9,100.00	\$ 350.00	\$ 12,250.00	\$ 168.00	\$ 5,880.00	
603.07	66-in RCP Storm Drain Class III	65	LF	\$ 250.00	\$ 16,250.00	\$ 421.00	\$ 27,365.00	\$ 375.00	\$ 24,375.00	\$ 388.00	\$ 25,220.00	\$ 426.00	\$ 27,690.00	

BID ABSTRACT
CITY OF NORTH LAS VEGAS
CENTENNIAL PARKWAY CHANNEL EAST
BID NO. 1304 - LABOR COMMISSION NO. PWP CL-2008-188
BID DATE: April 3, 2008

ITEM	DESCRIPTION	QTY	UNIT	ENGINEER'S ESTIMATE		EAGLE VIEW CONTRACTORS		FREHNEER CONSTRUCTION CO. INC.		RAFAEL CONSTRUCTION, INC.		MEADOW VALLEY CONTRACTORS, INC.	
				UNIT PRICE	TOTAL PRICE	UNIT PRICE	TOTAL PRICE	UNIT PRICE	TOTAL PRICE	UNIT PRICE	TOTAL PRICE	UNIT PRICE	TOTAL PRICE
603.08	24-in RCP Storm Drain Plug	1	EA	\$ 1,000.00	\$ 1,000.00	\$ 1,948.00	\$ 1,948.00	\$ 2,400.00	\$ 2,400.00	\$ 450.00	\$ 450.00	\$ 1,980.00	\$ 1,980.00
609.01	Access Storm Drain Manhole	31	EA	\$ 5,000.00	\$ 155,000.00	\$ 1,646.00	\$ 51,026.00	\$ 2,000.00	\$ 62,000.00	\$ 3,000.00	\$ 93,000.00	\$ 2,070.00	\$ 64,170.00
609.02	7.5-ft Modified Type 'C' Drop Inlet	2	EA	\$ 8,500.00	\$ 17,000.00	\$ 11,159.00	\$ 22,318.00	\$ 12,000.00	\$ 24,000.00	\$ 11,500.00	\$ 23,000.00	\$ 11,800.00	\$ 23,600.00
609.03	10-ft Modified Type 'C' Drop Inlet	2	EA	\$ 10,000.00	\$ 20,000.00	\$ 17,887.00	\$ 35,774.00	\$ 16,400.00	\$ 32,800.00	\$ 13,500.00	\$ 27,000.00	\$ 14,600.00	\$ 29,200.00
609.04	DELETED	0	EA	\$ -	\$ -	\$ -	\$ -	\$ -	\$ -	\$ -	\$ -	\$ -	\$ -
609.05	15-ft Modified Type 'C' Drop Inlet	2	EA	\$ 15,000.00	\$ 30,000.00	\$ 21,901.00	\$ 43,802.00	\$ 20,600.00	\$ 41,200.00	\$ 17,000.00	\$ 34,000.00	\$ 18,400.00	\$ 36,800.00
609.06	17.5-ft Modified Type 'C' Drop Inlet	3	EA	\$ 17,500.00	\$ 52,500.00	\$ 29,052.00	\$ 87,156.00	\$ 23,600.00	\$ 70,800.00	\$ 20,000.00	\$ 60,000.00	\$ 21,100.00	\$ 63,300.00
609.07	20-ft Modified Type 'C' Drop Inlet	1	EA	\$ 20,000.00	\$ 20,000.00	\$ 27,443.00	\$ 27,443.00	\$ 26,940.00	\$ 26,940.00	\$ 22,500.00	\$ 22,500.00	\$ 21,200.00	\$ 21,200.00
609.08	30-ft Modified Type 'C' Drop Inlet	1	EA	\$ 30,000.00	\$ 30,000.00	\$ 41,045.00	\$ 41,045.00	\$ 41,800.00	\$ 41,800.00	\$ 36,500.00	\$ 36,500.00	\$ 37,900.00	\$ 37,900.00
609.09	20-ft Trench Drain	1	EA	\$ 6,000.00	\$ 6,000.00	\$ 40,203.00	\$ 40,203.00	\$ 42,650.00	\$ 42,650.00	\$ 40,000.00	\$ 40,000.00	\$ 37,500.00	\$ 37,500.00
609.10	15-ft by 8-ft Grate Area Drain	2	EA	\$ 8,000.00	\$ 16,000.00	\$ 51,678.00	\$ 103,356.00	\$ 58,050.00	\$ 116,100.00	\$ 57,000.00	\$ 114,000.00	\$ 43,000.00	\$ 86,000.00
609.11	Unseal Existing Drop Inlet	1	EA	\$ 500.00	\$ 500.00	\$ 3,606.00	\$ 3,606.00	\$ 2,300.00	\$ 2,300.00	\$ 3,000.00	\$ 3,000.00	\$ 2,390.00	\$ 2,390.00
610.01	Riprap (D ₅₀ = 6-inch)	22	CY	\$ 90.00	\$ 1,980.00	\$ 55.00	\$ 1,210.00	\$ 197.00	\$ 4,334.00	\$ 155.00	\$ 3,410.00	\$ 188.00	\$ 4,136.00
610.02	Grouted Riprap	59	CY	\$ 125.00	\$ 7,375.00	\$ 99.00	\$ 5,841.00	\$ 291.00	\$ 17,169.00	\$ 200.00	\$ 11,800.00	\$ 159.00	\$ 9,381.00
610.03	Riprap Cutoff Wall	12	CY	\$ 140.00	\$ 1,680.00	\$ 110.00	\$ 1,320.00	\$ 239.00	\$ 2,868.00	\$ 175.00	\$ 2,100.00	\$ 501.00	\$ 6,012.00
613.01	Commercial Driveway Option "A"	280	SF	\$ 12.00	\$ 3,360.00	\$ 16.00	\$ 4,480.00	\$ 12.25	\$ 3,430.00	\$ 11.00	\$ 3,080.00	\$ 9.30	\$ 2,604.00
613.02	Modified Commercial Driveway Option "C"	4,500	SF	\$ 12.00	\$ 54,000.00	\$ 9.90	\$ 44,550.00	\$ 11.50	\$ 51,750.00	\$ 11.00	\$ 49,500.00	\$ 10.00	\$ 45,000.00
613.03	Concrete "L" Type Curb and Gutter	969	LF	\$ 10.00	\$ 9,690.00	\$ 20.40	\$ 19,767.60	\$ 24.00	\$ 23,256.00	\$ 22.00	\$ 21,318.00	\$ 22.50	\$ 21,802.50
613.04	Concrete Sidewalk	40,340	SF	\$ 5.00	\$ 201,700.00	\$ 4.31	\$ 173,865.40	\$ 4.65	\$ 187,581.00	\$ 6.00	\$ 242,040.00	\$ 4.40	\$ 177,496.00
613.05	Drainage Flume	66	LF	\$ 150.00	\$ 9,900.00	\$ 77.00	\$ 5,082.00	\$ 142.00	\$ 9,372.00	\$ 20.00	\$ 1,320.00	\$ 147.00	\$ 9,702.00
616.01	12-ft Double-Swing Chainlink Fence	3	EA	\$ 150.00	\$ 450.00	\$ 1,332.00	\$ 3,996.00	\$ 1,225.00	\$ 3,675.00	\$ 1,100.00	\$ 3,300.00	\$ 1,320.00	\$ 3,960.00
616.02	6-ft Chainlink Fence	1,725	LF	\$ 13.00	\$ 22,425.00	\$ 14.60	\$ 25,185.00	\$ 15.00	\$ 25,875.00	\$ 15.00	\$ 25,875.00	\$ 14.50	\$ 25,012.50
616.03	4-ft Post and Cable Railing	1,630	LF	\$ 10.00	\$ 16,300.00	\$ 10.10	\$ 16,463.00	\$ 11.00	\$ 17,930.00	\$ 17.00	\$ 27,710.00	\$ 10.00	\$ 16,300.00
618.01	Galvanized Guardrail (Triple Corrugation)	112	LF	\$ 30.00	\$ 3,360.00	\$ 105.00	\$ 11,760.00	\$ 89.00	\$ 9,968.00	\$ 130.00	\$ 14,560.00	\$ 87.00	\$ 9,744.00
623.01	Remove and Reset Street Light	34	EA	\$ 3,500.00	\$ 119,000.00	\$ 4,074.00	\$ 138,516.00	\$ 7,200.00	\$ 244,800.00	\$ 9,000.00	\$ 306,000.00	\$ 4,030.00	\$ 137,020.00
623.02	Remove and Reset Service Pedestal	3	EA	\$ 7,500.00	\$ 22,500.00	\$ 7,047.00	\$ 21,141.00	\$ 16,550.00	\$ 49,650.00	\$ 10,000.00	\$ 30,000.00	\$ 6,970.00	\$ 20,910.00
623.03	Remove and Relocate Fiber Optics Pulbox	3	EA	\$ 450.00	\$ 1,350.00	\$ 451.00	\$ 1,353.00	\$ 3,300.00	\$ 9,900.00	\$ 5,000.00	\$ 15,000.00	\$ 446.00	\$ 1,338.00
623.04	Remove and Relocate Fiber Optics Conduit	284	LF	\$ 20.00	\$ 5,680.00	\$ 20.00	\$ 5,680.00	\$ 138.00	\$ 39,192.00	\$ 30.00	\$ 8,520.00	\$ 19.50	\$ 5,538.00
627.01	Channel Identifier Sign	1	EA	\$ 100.00	\$ 100.00	\$ 138.00	\$ 138.00	\$ 138.00	\$ 138.00	\$ 500.00	\$ 500.00	\$ 136.00	\$ 136.00
627.02	Warning Sign	5	Ea	\$ 170.00	\$ 850.00	\$ 160.00	\$ 800.00	\$ 160.00	\$ 800.00	\$ 350.00	\$ 1,750.00	\$ 158.00	\$ 790.00
629.01	Relocate 6-inch Waterline	66	LF	\$ 125.00	\$ 8,250.00	\$ 222.00	\$ 14,652.00	\$ 268.00	\$ 17,688.00	\$ 400.00	\$ 26,400.00	\$ 229.00	\$ 15,114.00
629.02	Relocate 8-inch Waterline	56	LF	\$ 3,300.00	\$ 184,800.00	\$ 275.00	\$ 15,400.00	\$ 400.00	\$ 22,400.00	\$ 400.00	\$ 22,400.00	\$ 274.00	\$ 15,344.00
629.03	Relocate 12-inch Waterline	43	LF	\$ 400.00	\$ 17,200.00	\$ 323.00	\$ 13,889.00	\$ 421.00	\$ 18,103.00	\$ 400.00	\$ 17,200.00	\$ 378.00	\$ 16,254.00
629.04	Relocate Fire Hydrant	3	EA	\$ 5,500.00	\$ 16,500.00	\$ 8,863.00	\$ 26,589.00	\$ 3,600.00	\$ 10,800.00	\$ 3,800.00	\$ 11,400.00	\$ 5,290.00	\$ 15,870.00
629.05	18-inch Steel Sleeve at Sta. 86+43	37	LF	\$ 150.00	\$ 5,550.00	\$ 350.00	\$ 12,950.00	\$ 230.00	\$ 8,510.00	\$ 130.00	\$ 4,810.00	\$ 152.00	\$ 5,624.00
629.06	30-inch Steel Sleeve at Sta 90+30	60	LF	\$ 250.00	\$ 15,000.00	\$ 322.00	\$ 19,320.00	\$ 238.00	\$ 14,280.00	\$ 215.00	\$ 12,900.00	\$ 239.00	\$ 14,340.00
629.07	Bore and Jack 18-inch Steel Sleeve - 8-inch Waterline Sta. 109+56	64	LF	\$ 900.00	\$ 57,600.00	\$ 328.00	\$ 20,992.00	\$ 1,539.00	\$ 98,496.00	\$ 850.00	\$ 54,400.00	\$ 852.00	\$ 54,528.00
629.08	Verify Existence of 18-inch Steel Sleeve - 8-inch Waterline Sta. 50+98	1	LS	\$ 3,500.00	\$ 3,500.00	\$ 2,026.00	\$ 2,026.00	\$ 3,055.00	\$ 3,055.00	\$ 1,000.00	\$ 1,000.00	\$ 3,700.00	\$ 3,700.00
629.09	Verify Existence of 24-inch Steel Sleeve - 12-inch Waterline Sta. 36+12	1	LS	\$ 3,500.00	\$ 3,500.00	\$ 2,026.00	\$ 2,026.00	\$ 3,190.00	\$ 3,190.00	\$ 1,000.00	\$ 1,000.00	\$ 3,700.00	\$ 3,700.00
629.10	Verify Existence of 24-inch Steel Sleeve - 12-inch Waterline Sta. 103+35	1	LS	\$ 3,500.00	\$ 3,500.00	\$ 2,026.00	\$ 2,026.00	\$ 3,060.00	\$ 3,060.00	\$ 1,000.00	\$ 1,000.00	\$ 3,700.00	\$ 3,700.00
629.11	18-inch Steel Sleeve - 8-inch Waterline Sta. 50+98	36	LF	\$ 400.00	\$ 14,400.00	\$ 227.00	\$ 8,172.00	\$ 420.00	\$ 15,120.00	\$ 270.00	\$ 9,720.00	\$ 367.00	\$ 13,212.00
629.12	24-inch Steel Sleeve - 12-inch Water line Sta. 36+12	104	LF	\$ 250.00	\$ 26,000.00	\$ 300.00	\$ 31,200.00	\$ 389.00	\$ 40,456.00	\$ 170.00	\$ 17,680.00	\$ 202.00	\$ 21,008.00
629.13	24-inch Steel Sleeve - 12-inch Waterline Sta. 103+35	78	LF	\$ 200.00	\$ 15,600.00	\$ 330.00	\$ 25,740.00	\$ 372.00	\$ 29,016.00	\$ 350.00	\$ 27,300.00	\$ 179.00	\$ 13,962.00
630.01	Extend 12-inch PVC Sanitary Sewer Pipe	140	LF	\$ 100.00	\$ 14,000.00	\$ 119.00	\$ 16,660.00	\$ 190.00	\$ 26,600.00	\$ 135.00	\$ 18,900.00	\$ 113.00	\$ 15,820.00

BID ABSTRACT
CITY OF NORTH LAS VEGAS
CENTENNIAL PARKWAY CHANNEL EAST
BID NO. 1304 - LABOR COMMISSION NO. PWP CL-2008-188
BID DATE: April 3, 2008

ITEM	DESCRIPTION	QTY	UNIT	ENGINEER'S ESTIMATE		EAGLE VIEW CONTRACTORS		FREHNEER CONSTRUCTION CO. INC.		RAFAEL CONSTRUCTION, INC.		MEADOW VALLEY CONTRACTORS, INC.	
				UNIT PRICE	TOTAL PRICE	UNIT PRICE	TOTAL PRICE	UNIT PRICE	TOTAL PRICE	UNIT PRICE	TOTAL PRICE	UNIT PRICE	TOTAL PRICE
630.02	18-inch Steel Sleeve - 8-inch Sanitary Sewer Sta. 50+86	36	LF	\$ 400.00	\$ 14,400.00	\$ 248.00	\$ 8,928.00	\$ 295.00	\$ 10,620.00	\$ 550.00	\$ 19,800.00	\$ 400.00	\$ 14,400.00
630.03	18-inch Steel Sleeve - 8-inch Sanitary Sewer Sta. 114+48	64	LF	\$ 300.00	\$ 19,200.00	\$ 297.00	\$ 19,008.00	\$ 290.00	\$ 18,560.00	\$ 475.00	\$ 30,400.00	\$ 281.00	\$ 17,984.00
630.04	20-inch Steel Sleeve - 10-inch Sanitary Sewer Sta. 116+49	64	LF	\$ 300.00	\$ 19,200.00	\$ 299.00	\$ 19,136.00	\$ 300.00	\$ 19,200.00	\$ 500.00	\$ 32,000.00	\$ 290.00	\$ 18,560.00
630.05	Bore and Jack 20-inch Steel Sleeve - 10-inch Sanitary Sewer Sta. 103+16	64	LF	\$ 300.00	\$ 19,200.00	\$ 374.00	\$ 23,936.00	\$ 1,830.00	\$ 117,120.00	\$ 650.00	\$ 41,600.00	\$ 854.00	\$ 54,656.00
630.06	Remove and Dispose of 12-inch Sanitary Sewer	39	LF	\$ 500.00	\$ 19,500.00	\$ 70.00	\$ 2,730.00	\$ 57.00	\$ 2,223.00	\$ 40.00	\$ 1,560.00	\$ 372.00	\$ 14,508.00
630.07	Remove and Dispose of Sanitary Sewer Manhole	1	EA	\$ 1,600.00	\$ 1,600.00	\$ 2,604.00	\$ 2,604.00	\$ 1,690.00	\$ 1,690.00	\$ 2,500.00	\$ 2,500.00	\$ 1,430.00	\$ 1,430.00
630.08	Sanitary Sewer Manhole	2	EA	\$ 5,000.00	\$ 10,000.00	\$ 1,729.00	\$ 3,458.00	\$ 5,525.00	\$ 11,050.00	\$ 3,500.00	\$ 7,000.00	\$ 4,380.00	\$ 8,760.00
637.01	Dust Control	1	LS	\$ 47,000.00	\$ 47,000.00	\$ 79,279.00	\$ 79,279.00	\$ 91,200.00	\$ 91,200.00	\$ 120,000.00	\$ 120,000.00	\$ 64,000.00	\$ 64,000.00
637.02	Dust Palliative	3	AC	\$ 1,000.00	\$ 3,000.00	\$ 3,670.00	\$ 11,010.00	\$ 1,400.00	\$ 4,200.00	\$ 2,500.00	\$ 7,500.00	\$ 1,630.00	\$ 4,890.00
TOTAL BASE BID					\$ 7,156,985.00		\$ 7,785,433.00		\$ 8,151,091.00		\$ 7,107,073.00		\$ 6,892,106.50

ADDITIVE/DEDUCTIVE													
212.02	Modify Landscaping and Irrigation System - Centennial 5 Retail Center	1	LS	\$ 18,000.00	\$ 18,000.00	\$ 18,479.00	\$ 18,479.00	\$ 18,600.00	\$ 18,600.00	\$ 55,000.00	\$ 55,000.00	\$ 18,300.00	\$ 18,300.00
613.06	Concrete Sidewalk - Centennial 5 Retail Center	5,160	SF	\$ 4.00	\$ 20,640.00	\$ 4.30	\$ 22,188.00	\$ 4.60	\$ 23,736.00	\$ 8.00	\$ 41,280.00	\$ 4.40	\$ 22,704.00
TOTAL ADDITIVE/DEDUCTIVE					\$ 38,640.00		\$ 40,667.00		\$ 42,336.00		\$ 96,280.00		\$ 41,004.00

ADDITIVE ALTERNATE A (PRECAST)													
509.01A	8-ft by 6-ft Precast RCB Storm Drain	77	LF	\$ 950.00	\$ 73,150.00	\$ -	\$ -	\$ -	\$ -	\$ 1,100.00	\$ 84,700.00	\$ 1,123.00	\$ 86,471.00
509.02A	14-ft by 6-ft Precast RCB Storm Drain	1,319	LF	\$ 1,050.00	\$ 1,384,950.00	\$ -	\$ -	\$ -	\$ -	\$ 900.00	\$ 1,187,100.00	\$ 1,015.00	\$ 1,338,785.00
509.03A	15-ft by 6-ft Precast RCB Storm Drain	1,327	LF	\$ 1,150.00	\$ 1,526,050.00	\$ -	\$ -	\$ -	\$ -	\$ 920.00	\$ 1,220,840.00	\$ 890.00	\$ 1,181,030.00
509.04A	15-ft by 7-ft Precast RCB Storm Drain	1,710	LF	\$ 1,200.00	\$ 2,052,000.00	\$ -	\$ -	\$ -	\$ -	\$ 930.00	\$ 1,590,300.00	\$ 972.00	\$ 1,662,120.00
509.05A	Double 15-ft by 6-ft Precast RCB Storm Drain	88	LF	\$ 2,000.00	\$ 176,000.00	\$ -	\$ -	\$ -	\$ -	\$ 1,910.00	\$ 168,080.00	\$ 1,705.00	\$ 150,040.00
509.06A	Double 20-ft by 6-ft Precast RCB Storm Drain	3,341	LF	\$ 2,500.00	\$ 8,352,500.00	\$ -	\$ -	\$ -	\$ -	\$ 2,450.00	\$ 8,185,450.00	\$ 2,453.00	\$ 8,195,473.00
TOTAL ADDITIVE ALTERNATE A					\$ 13,564,650.00		\$ -		\$ -		\$ 12,436,470.00		\$ 12,613,919.00

ADDITIVE ALTERNATE B (CAST-IN-PLACE)													
502.01B	8-ft by 6-ft Precast RCB Storm Drain	77	LF	\$ 950.00	\$ 73,150.00	\$ 923.50	\$ 71,109.50	\$ 761.00	\$ 58,597.00	\$ -	\$ -	\$ -	\$ -
502.02B	14-ft by 6-ft Cast-in-Place RCB Storm Drain	1,319	LF	\$ 1,050.00	\$ 1,384,950.00	\$ 842.40	\$ 1,111,125.60	\$ 913.00	\$ 1,204,247.00	\$ -	\$ -	\$ -	\$ -
502.03B	15-ft by 6-ft Cast-in-Place RCB Storm Drain	1,327	LF	\$ 1,150.00	\$ 1,526,050.00	\$ 891.40	\$ 1,182,887.80	\$ 933.00	\$ 1,238,091.00	\$ -	\$ -	\$ -	\$ -
502.04B	15-ft by 7-ft Cast-in-Place RCB Storm Drain	1,710	LF	\$ 1,200.00	\$ 2,052,000.00	\$ 928.10	\$ 1,587,051.00	\$ 942.00	\$ 1,610,820.00	\$ -	\$ -	\$ -	\$ -
502.05B	Double 15-ft by 6-ft Cast-in-Place RCB Storm Drain	88	LF	\$ 2,000.00	\$ 176,000.00	\$ 1,949.00	\$ 171,512.00	\$ 1,705.00	\$ 150,040.00	\$ -	\$ -	\$ -	\$ -
502.06B	Double 20-ft by 6-ft Cast-in-Place RCB Storm Drain	3,341	LF	\$ 2,500.00	\$ 8,352,500.00	\$ 1,975.00	\$ 6,598,475.00	\$ 1,885.00	\$ 6,297,785.00	\$ -	\$ -	\$ -	\$ -
TOTAL ADDITIVE ALTERNATE B					\$ 13,564,650.00		\$ 10,722,160.90		\$ 10,559,580.00		\$ -		\$ -

TOTAL BID INCLUDING ALTERNATE A					\$ 20,721,635.00						\$ 19,543,543.00		\$ 19,506,025.50
--	--	--	--	--	-------------------------	--	--	--	--	--	-------------------------	--	-------------------------

TOTAL BID INCLUDING ALTERNATE B					\$ 20,721,635.00		\$ 18,507,593.90		\$ 18,710,671.00				
--	--	--	--	--	-------------------------	--	-------------------------	--	-------------------------	--	--	--	--

BID ABSTRACT
CITY OF NORTH LAS VEGAS
CENTENNIAL PARKWAY CHANNEL EAST
BID NO. 1304 - LABOR COMMISSION NO. PWP CL-2008-188
BID DATE: April 3, 2008

				ENGINEER'S ESTIMATE		EAGLE VIEW CONTRACTORS		FREHNEER CONSTRUCTION CO. INC.			RAFAEL CONSTRUCTION, INC.		MEADOW VALLEY CONTRACTORS, INC.	
ITEM	DESCRIPTION	QTY	UNIT	UNIT PRICE	TOTAL PRICE	UNIT PRICE	TOTAL PRICE	UNIT PRICE	TOTAL PRICE	UNIT PRICE	TOTAL PRICE	UNIT PRICE	TOTAL PRICE	
Subcontractors:				Concrete Work		Rowley Contracting		Stewart & Sundell						
				Steel Fabrication & Erection		Pacific Coast Steel								
				Landscape		Walker Landscape		Sonoran Companies						
				Traffic Control		Superior Traffic Services								
				Electrical		Wheeler's Electric		Sequoia Electrical						
				Manholes				Olsen Precast						
				Drop Inlets						Stewart & Sundell Concrete				
				Signage										
				Fencing										
Suppliers:				Reinforced Concrete Pipe		Geneva Pipe		Geneva Pipe		Rinker Materials		Hydro Conduit Corp		
				Reinforced Concrete Box		N/A		Cast-in-Place		Rinker Materials		Hydro Conduit Corp		
				Type II Aggregate Base		Las Vegas Paving		Diamond Construction		Diamond Construction		Nevada Redi Mix		
				Portland Cement Concrete		Service Rock Products		Sierra Ready Mix		Ready Mix Inc.		Ready Mix Inc.		
				Sewer and Water Pipes		Ferguson Waterworks		Steve Wernerbo Cassiaway		Ferguson Waterworks		HD Supply		

Glenda Washmeyer
Prepared By

KWC Remyse
Checked By

NOTES:

- A. Bidder listed total amount for Item 630.02 as \$89,028.00; correct amount is \$8,928. Bid Total amount is correct as listed.
- B. Bidder did not list an amount for Traffic Control - Item 107.01.
- C. Bidder listed Total Base Bid amount as \$6,961,706.50; correct amount is \$6,892,106.50.
- D. Bidder listed Total Bid (Alt. B + Base Bid) as \$19,575,625.50; correct amount is \$19,506,025.50.

BID ABSTRACT
CITY OF NORTH LAS VEGAS
CENTENNIAL PARKWAY CHANNEL EAST
BID NO. 1304 - LABOR COMMISSION NO. PWP CL-2008-188
BID DATE: April 3, 2008

ITEM	DESCRIPTION	QTY	UNIT	ENGINEER'S ESTIMATE		LAS VEGAS PAVING CORPORATION		CONTRI CONSTRUCTION COMPANY		ROAD & HIGHWAY BUILDERS, LLC.		DON KELLY CONSTRUCTION, INC.	
				UNIT PRICE	TOTAL PRICE	UNIT PRICE	TOTAL PRICE	UNIT PRICE	TOTAL PRICE	UNIT PRICE	TOTAL PRICE	UNIT PRICE	TOTAL PRICE
107.01	Traffic Control	1	LS	\$ 90,000.00	\$ 90,000.00	\$ 100,000.00	\$ 100,000.00	\$ 269,812.00	\$ 269,812.00	\$ 150,000.00	\$ 150,000.00	\$ 250,000.00	\$ 250,000.00
108.01	Partnering Workshop	1	LS	\$ 7,500.00	\$ 7,500.00	\$ 7,500.00	\$ 7,500.00	\$ 7,500.00	\$ 7,500.00	\$ 7,500.00	\$ 7,500.00	\$ 7,500.00	\$ 7,500.00
109.01	Construction Conflict	1	LS	\$ 750,000.00	\$ 750,000.00	\$ 750,000.00	\$ 750,000.00	\$ 750,000.00	\$ 750,000.00	\$ 750,000.00	\$ 750,000.00	\$ 750,000.00	\$ 750,000.00
200.01	Mobilization	1	LS	\$ 1,000,000.00	\$ 1,000,000.00	\$ 725,000.00	\$ 725,000.00	\$ 1,150,000.00	\$ 1,150,000.00	\$ 1,557,295.50	\$ 1,557,295.50	\$ 2,000,000.00	\$ 2,000,000.00
201.01	Clearing and Grubbing	1	LS	\$ 20,000.00	\$ 20,000.00	\$ 34,000.00	\$ 34,000.00	\$ 40,000.00	\$ 40,000.00	\$ 250,000.00	\$ 250,000.00	\$ 25,000.00	\$ 25,000.00
202.01	Remove Headwall at Sta. 36+10	1	LS	\$ 5,000.00	\$ 5,000.00	\$ 7,000.00	\$ 7,000.00	\$ 3,900.00	\$ 3,900.00	\$ 500.00	\$ 500.00	\$ 25,000.00	\$ 25,000.00
202.02	Remove Headwall (Wingwalls Only)	4	EA	\$ 3,000.00	\$ 12,000.00	\$ 2,000.00	\$ 8,000.00	\$ 4,935.00	\$ 19,740.00	\$ 500.00	\$ 2,000.00	\$ 12,500.00	\$ 50,000.00
202.03	Remove Portion of 16-ft by 6-ft Reinforced Concrete Arch Culvert from Sta. 36+10 to Sta. 36+64	54	LF	\$ 150.00	\$ 8,100.00	\$ 242.00	\$ 13,068.00	\$ 157.00	\$ 8,478.00	\$ 200.00	\$ 10,800.00	\$ 1,200.00	\$ 64,800.00
202.04	Remove Curb and Gutter	1,460	LF	\$ 5.00	\$ 7,300.00	\$ 8.00	\$ 11,680.00	\$ 12.00	\$ 17,520.00	\$ 5.00	\$ 7,300.00	\$ 56.00	\$ 81,760.00
202.05	Remove Concrete Sidewalk	28,500	SF	\$ 2.00	\$ 57,000.00	\$ 1.00	\$ 28,500.00	\$ 1.20	\$ 34,200.00	\$ 0.50	\$ 14,250.00	\$ 7.00	\$ 199,500.00
202.06	Remove AC Pavement Path	3,250	LF	\$ 4.00	\$ 13,000.00	\$ 4.00	\$ 13,000.00	\$ 3.30	\$ 10,725.00	\$ 0.50	\$ 1,625.00	\$ 15.00	\$ 48,750.00
202.07	Remove AC Pavement	3,900	SY	\$ 5.00	\$ 19,500.00	\$ 4.00	\$ 15,600.00	\$ 4.75	\$ 18,525.00	\$ 20.00	\$ 78,000.00	\$ 15.00	\$ 58,500.00
202.08	Remove Bubbler Structure at Sta. 49+12	1	LS	\$ 4,000.00	\$ 4,000.00	\$ 1,300.00	\$ 1,300.00	\$ 11,890.00	\$ 11,890.00	\$ 2,500.00	\$ 2,500.00	\$ 50,000.00	\$ 50,000.00
202.09	Remove Grouted Riprap at Revere	208	CY	\$ 50.00	\$ 10,400.00	\$ 22.00	\$ 4,576.00	\$ 83.00	\$ 17,264.00	\$ 50.00	\$ 10,400.00	\$ 118.00	\$ 24,544.00
202.10	Remove 6-inch Riprap from Sta. 103+60 to Sta. 109+42	2,250	CY	\$ 15.00	\$ 33,750.00	\$ 16.00	\$ 36,000.00	\$ 21.00	\$ 47,250.00	\$ 0.22	\$ 495.00	\$ 41.00	\$ 92,250.00
202.11	Remove Concrete Channel Bottom from Sta. 103+60 to Sta. 116+00	1,500	SY	\$ 25.00	\$ 37,500.00	\$ 10.00	\$ 15,000.00	\$ 10.00	\$ 15,000.00	\$ 0.53	\$ 795.00	\$ 125.00	\$ 187,500.00
202.12	Remove Wrought Iron Fence (Donna to Bruce)	1,332	LF	\$ 5.00	\$ 6,660.00	\$ 3.00	\$ 3,996.00	\$ 5.50	\$ 7,326.00	\$ 5.00	\$ 6,660.00	\$ 15.00	\$ 19,980.00
202.13	Remove Retaining Wall	1	LS	\$ 12,000.00	\$ 12,000.00	\$ 12,300.00	\$ 12,300.00	\$ 12,455.00	\$ 12,455.00	\$ 10,000.00	\$ 10,000.00	\$ 31,000.00	\$ 31,000.00
202.14	Remove and Reset Marquee Sign	1	LS	\$ 5,000.00	\$ 5,000.00	\$ 13,750.00	\$ 13,750.00	\$ 11,560.00	\$ 11,560.00	\$ 10,000.00	\$ 10,000.00	\$ 10,000.00	\$ 10,000.00
203.01	Channel Excavation	120,000	CY	\$ 15.00	\$ 1,800,000.00	\$ 1.00	\$ 120,000.00	\$ 11.00	\$ 1,320,000.00	\$ 30.00	\$ 3,600,000.00	\$ 1.00	\$ 120,000.00
203.02	Over-Excavation	12,000	CY	\$ 8.00	\$ 96,000.00	\$ 22.00	\$ 264,000.00	\$ 17.00	\$ 204,000.00	\$ 10.00	\$ 120,000.00	\$ 1.00	\$ 12,000.00
208.01	Permanent Pavement Patch	820	TN	\$ 90.00	\$ 73,800.00	\$ 140.00	\$ 114,800.00	\$ 200.00	\$ 164,000.00	\$ 50.00	\$ 41,000.00	\$ 140.00	\$ 114,800.00
212.01	Modify Landscaping and Irrigation System	1	LS	\$ 600,000.00	\$ 600,000.00	\$ 520,000.00	\$ 520,000.00	\$ 965,535.00	\$ 965,535.00	\$ 500,000.00	\$ 500,000.00	\$ 550,000.00	\$ 550,000.00
302.01	Type II Access Road & Manway	401	TN	\$ 20.00	\$ 8,020.00	\$ 14.00	\$ 5,614.00	\$ 41.00	\$ 16,441.00	\$ 60.00	\$ 24,060.00	\$ 107.00	\$ 42,907.00
502.01	Transition Structure from Sta. 27+63 to Sta. 30+00	1	LS	\$ 177,750.00	\$ 177,750.00	\$ 201,000.00	\$ 201,000.00	\$ 154,585.00	\$ 154,585.00	\$ 500,000.00	\$ 500,000.00	\$ 225,000.00	\$ 225,000.00
502.02	Junction Structure at Revere Street from Sta. 36+26 to Sta. 36+64	1	LS	\$ 40,200.00	\$ 40,200.00	\$ 110,000.00	\$ 110,000.00	\$ 92,850.00	\$ 92,850.00	\$ 200,000.00	\$ 200,000.00	\$ 120,000.00	\$ 120,000.00
502.03	Transition Structure from Sta. 49+11 to Sta. 49+74	1	LS	\$ 45,900.00	\$ 45,900.00	\$ 62,500.00	\$ 62,500.00	\$ 50,660.00	\$ 50,660.00	\$ 150,000.00	\$ 150,000.00	\$ 90,000.00	\$ 90,000.00
502.04	Junction Structure from Sta. 63+52 to Sta. 63+70	1	LS	\$ 25,200.00	\$ 25,200.00	\$ 56,000.00	\$ 56,000.00	\$ 42,655.00	\$ 42,655.00	\$ 150,000.00	\$ 150,000.00	\$ 90,000.00	\$ 90,000.00
502.05	Transition Structure from Sta. 63+70 to Sta. 63+88	1	LS	\$ 20,000.00	\$ 20,000.00	\$ 41,000.00	\$ 41,000.00	\$ 5,760.00	\$ 5,760.00	\$ 150,000.00	\$ 150,000.00	\$ 62,000.00	\$ 62,000.00
502.06	Transition Structure from Sta. 80+98 to Sta. 81+08	1	LS	\$ 30,000.00	\$ 30,000.00	\$ 15,000.00	\$ 15,000.00	\$ 16,490.00	\$ 16,490.00	\$ 15,000.00	\$ 15,000.00	\$ 70,000.00	\$ 70,000.00
502.07	Transition Structure from Sta. 90+77 to Sta. 90+93	1	LS	\$ 250,000.00	\$ 250,000.00	\$ 55,000.00	\$ 55,000.00	\$ 32,915.00	\$ 32,915.00	\$ 150,000.00	\$ 150,000.00	\$ 90,000.00	\$ 90,000.00
502.08	Transition Structure from Sta. 91+79 to Sta. 92+79	1	LS	\$ 100,000.00	\$ 100,000.00	\$ 333,000.00	\$ 333,000.00	\$ 243,930.00	\$ 243,930.00	\$ 400,000.00	\$ 400,000.00	\$ 185,000.00	\$ 185,000.00
502.09	Transition Structure from Sta. 126+19 to Sta. 126+44	1	LS	\$ 42,750.00	\$ 42,750.00	\$ 129,000.00	\$ 129,000.00	\$ 72,545.00	\$ 72,545.00	\$ 150,000.00	\$ 150,000.00	\$ 75,000.00	\$ 75,000.00
502.10	15-ft by 6.5 ft Rectangular Concrete Channel from Sta. 30+00 to Sta. 35+53 including Transition	553	LF	\$ 435.00	\$ 240,555.00	\$ 653.00	\$ 361,109.00	\$ 490.00	\$ 270,970.00	\$ 850.00	\$ 470,050.00	\$ 550.00	\$ 304,150.00
502.11	Headwall for 15-ft by 6-ft RCB (Revere St.)	1	LS	\$ 15,000.00	\$ 15,000.00	\$ 24,700.00	\$ 24,700.00	\$ 15,240.00	\$ 15,240.00	\$ 15,000.00	\$ 15,000.00	\$ 7,200.00	\$ 7,200.00
502.12	Headwall for 15-ft by 6-ft RCB (Centennial St.)	1	LS	\$ 15,000.00	\$ 15,000.00	\$ 15,400.00	\$ 15,400.00	\$ 15,240.00	\$ 15,240.00	\$ 15,000.00	\$ 15,000.00	\$ 7,200.00	\$ 7,200.00
502.13	Flow Equalization Structure	2	EA	\$ 15,000.00	\$ 30,000.00	\$ 2,500.00	\$ 5,000.00	\$ 870.00	\$ 1,740.00	\$ 1,000.00	\$ 2,000.00	\$ 11,000.00	\$ 22,000.00
603.01	18-in RCP Storm Drain Class III	217	LF	\$ 100.00	\$ 21,700.00	\$ 142.00	\$ 30,814.00	\$ 245.00	\$ 53,165.00	\$ 200.00	\$ 43,400.00	\$ 505.00	\$ 109,585.00
603.02	24-in RCP Storm Drain Class III	113	LF	\$ 125.00	\$ 14,125.00	\$ 175.00	\$ 19,775.00	\$ 350.00	\$ 39,550.00	\$ 225.00	\$ 25,425.00	\$ 581.00	\$ 65,653.00
603.03	30-in RCP Storm Drain Class III	104	LF	\$ 150.00	\$ 15,600.00	\$ 211.00	\$ 21,944.00	\$ 322.00	\$ 33,488.00	\$ 275.00	\$ 28,600.00	\$ 284.00	\$ 29,536.00
603.04	36-in RCP Storm Drain Class III	19	LF	\$ 175.00	\$ 3,325.00	\$ 284.00	\$ 5,396.00	\$ 595.00	\$ 11,305.00	\$ 400.00	\$ 7,600.00	\$ 1,160.00	\$ 22,040.00
603.05	42-in RCP Storm Drain Class III	10	LF	\$ 190.00	\$ 1,900.00	\$ 325.00	\$ 3,250.00	\$ 605.00	\$ 6,050.00	\$ 500.00	\$ 5,000.00	\$ 2,182.00	\$ 21,820.00
603.06	48-in RCP Storm Drain Class III	35	LF	\$ 200.00	\$ 7,000.00	\$ 333.00	\$ 11,655.00	\$ 606.00	\$ 21,210.00	\$ 650.00	\$ 22,750.00	\$ 705.00	\$ 24,675.00
603.07	66-in RCP Storm Drain Class III	65	LF	\$ 250.00	\$ 16,250.00	\$ 465.00	\$ 30,225.00	\$ 450.00	\$ 29,250.00	\$ 750.00	\$ 48,750.00	\$ 1,458.00	\$ 94,770.00

BID ABSTRACT
CITY OF NORTH LAS VEGAS
CENTENNIAL PARKWAY CHANNEL EAST
BID NO. 1304 - LABOR COMMISSION NO. PWP CL-2008-188
BID DATE: April 3, 2008

ITEM	DESCRIPTION	QTY	UNIT	ENGINEER'S ESTIMATE		LAS VEGAS PAVING CORPORATION		CONTRI CONSTRUCTION COMPANY		ROAD & HIGHWAY BUILDERS, LLC.		DON KELLY CONSTRUCTION, INC.	
				UNIT PRICE	TOTAL PRICE	UNIT PRICE	TOTAL PRICE	UNIT PRICE	TOTAL PRICE	UNIT PRICE	TOTAL PRICE	UNIT PRICE	TOTAL PRICE
603.08	24-in RCP Storm Drain Plug	1	EA	\$ 1,000.00	\$ 1,000.00	\$ 1,000.00	\$ 1,000.00	\$ 1,810.00	\$ 1,810.00	\$ 1,000.00	\$ 1,000.00	\$ 3,000.00	\$ 3,000.00
609.01	Access Storm Drain Manhole	31	EA	\$ 5,000.00	\$ 155,000.00	\$ 2,250.00	\$ 69,750.00	\$ 1,800.00	\$ 55,800.00	\$ 4,500.00	\$ 139,500.00	\$ 3,500.00	\$ 108,500.00
609.02	7.5-ft Modified Type 'C' Drop Inlet	2	EA	\$ 8,500.00	\$ 17,000.00	\$ 9,000.00	\$ 18,000.00	\$ 11,705.00	\$ 23,410.00	\$ 15,000.00	\$ 30,000.00	\$ 28,000.00	\$ 56,000.00
609.03	10-ft Modified Type 'C' Drop Inlet	2	EA	\$ 10,000.00	\$ 20,000.00	\$ 11,300.00	\$ 22,600.00	\$ 15,830.00	\$ 31,660.00	\$ 20,000.00	\$ 40,000.00	\$ 31,000.00	\$ 62,000.00
609.04	DELETED	0	EA	\$ -	\$ -	\$ -	\$ -	\$ -	\$ -	\$ -	\$ -	\$ -	\$ -
609.05	15-ft Modified Type 'C' Drop Inlet	2	EA	\$ 15,000.00	\$ 30,000.00	\$ 15,200.00	\$ 30,400.00	\$ 20,695.00	\$ 41,390.00	\$ 25,000.00	\$ 50,000.00	\$ 35,000.00	\$ 70,000.00
609.06	17.5-ft Modified Type 'C' Drop Inlet	3	EA	\$ 17,500.00	\$ 52,500.00	\$ 17,700.00	\$ 53,100.00	\$ 23,735.00	\$ 71,205.00	\$ 30,000.00	\$ 90,000.00	\$ 31,000.00	\$ 93,000.00
609.07	20-ft Modified Type 'C' Drop Inlet	1	EA	\$ 20,000.00	\$ 20,000.00	\$ 20,000.00	\$ 20,000.00	\$ 23,745.00	\$ 23,745.00	\$ 40,000.00	\$ 40,000.00	\$ 42,000.00	\$ 42,000.00
609.08	30-ft Modified Type 'C' Drop Inlet	1	EA	\$ 30,000.00	\$ 30,000.00	\$ 33,000.00	\$ 33,000.00	\$ 44,475.00	\$ 44,475.00	\$ 50,000.00	\$ 50,000.00	\$ 55,000.00	\$ 55,000.00
609.09	20-ft Trench Drain	1	EA	\$ 6,000.00	\$ 6,000.00	\$ 35,000.00	\$ 35,000.00	\$ 41,050.00	\$ 41,050.00	\$ 50,000.00	\$ 50,000.00	\$ 58,000.00	\$ 58,000.00
609.10	15-ft by 8-ft Grate Area Drain	2	EA	\$ 8,000.00	\$ 16,000.00	\$ 55,000.00	\$ 110,000.00	\$ 53,345.00	\$ 106,690.00	\$ 30,000.00	\$ 60,000.00	\$ 63,000.00	\$ 126,000.00
609.11	Unseal Existing Drop Inlet	1	EA	\$ 500.00	\$ 500.00	\$ 600.00	\$ 600.00	\$ 695.00	\$ 695.00	\$ 1,000.00	\$ 1,000.00	\$ 7,500.00	\$ 7,500.00
610.01	Riprap (D ₅₀ = 6-inch)	22	CY	\$ 90.00	\$ 1,980.00	\$ 40.00	\$ 880.00	\$ 135.00	\$ 2,970.00	\$ 200.00	\$ 4,400.00	\$ 372.00	\$ 8,184.00
610.02	Grouted Riprap	59	CY	\$ 125.00	\$ 7,375.00	\$ 65.00	\$ 3,835.00	\$ 120.00	\$ 7,080.00	\$ 250.00	\$ 14,750.00	\$ 198.00	\$ 11,682.00
610.03	Riprap Cutoff Wall	12	CY	\$ 140.00	\$ 1,680.00	\$ 200.00	\$ 2,400.00	\$ 116.00	\$ 1,392.00	\$ 225.00	\$ 2,700.00	\$ 633.00	\$ 7,596.00
613.01	Commercial Driveway Option "A"	280	SF	\$ 12.00	\$ 3,360.00	\$ 18.00	\$ 5,040.00	\$ 17.00	\$ 4,760.00	\$ 8.00	\$ 2,240.00	\$ 15.00	\$ 4,200.00
613.02	Modified Commercial Driveway Option "C"	4,500	SF	\$ 12.00	\$ 54,000.00	\$ 18.00	\$ 81,000.00	\$ 16.50	\$ 74,250.00	\$ 8.00	\$ 36,000.00	\$ 15.00	\$ 67,500.00
613.03	Concrete "L" Type Curb and Gutter	969	LF	\$ 10.00	\$ 9,690.00	\$ 35.00	\$ 33,915.00	\$ 36.00	\$ 34,884.00	\$ 30.00	\$ 29,070.00	\$ 30.00	\$ 29,070.00
613.04	Concrete Sidewalk	40,340	SF	\$ 5.00	\$ 201,700.00	\$ 7.00	\$ 282,380.00	\$ 6.50	\$ 262,210.00	\$ 4.00	\$ 161,360.00	\$ 7.00	\$ 282,380.00
613.05	Drainage Flume	66	LF	\$ 150.00	\$ 9,900.00	\$ 220.00	\$ 14,520.00	\$ 65.00	\$ 4,290.00	\$ 50.00	\$ 3,300.00	\$ 21.00	\$ 1,386.00
616.01	12-ft Double-Swing Chainlink Fence	3	EA	\$ 150.00	\$ 450.00	\$ 1,500.00	\$ 4,500.00	\$ 1,290.00	\$ 3,870.00	\$ 1,115.00	\$ 3,345.00	\$ 1,500.00	\$ 4,500.00
616.02	6-ft Chainlink Fence	1,725	LF	\$ 13.00	\$ 22,425.00	\$ 15.00	\$ 25,875.00	\$ 16.00	\$ 27,600.00	\$ 13.50	\$ 23,287.50	\$ 18.00	\$ 31,050.00
616.03	4-ft Post and Cable Railing	1,630	LF	\$ 10.00	\$ 16,300.00	\$ 12.00	\$ 19,560.00	\$ 12.00	\$ 19,560.00	\$ 10.00	\$ 16,300.00	\$ 13.00	\$ 21,190.00
618.01	Galvanized Guardrail (Triple Corrugation)	112	LF	\$ 30.00	\$ 3,360.00	\$ 90.00	\$ 10,080.00	\$ 92.50	\$ 10,360.00	\$ 50.00	\$ 5,600.00	\$ 100.00	\$ 11,200.00
623.01	Remove and Reset Street Light	34	EA	\$ 3,500.00	\$ 119,000.00	\$ 3,500.00	\$ 119,000.00	\$ 11,490.00	\$ 390,660.00	\$ 8,000.00	\$ 272,000.00	\$ 9,000.00	\$ 306,000.00
623.02	Remove and Reset Service Pedestal	3	EA	\$ 7,500.00	\$ 22,500.00	\$ 4,000.00	\$ 12,000.00	\$ 32,945.00	\$ 98,835.00	\$ 10,000.00	\$ 30,000.00	\$ 4,500.00	\$ 13,500.00
623.03	Remove and Relocate Fiber Optics Pullbox	3	EA	\$ 450.00	\$ 1,350.00	\$ 4,000.00	\$ 12,000.00	\$ 580.00	\$ 1,740.00	\$ 1,125.00	\$ 3,375.00	\$ 1,300.00	\$ 3,900.00
623.04	Remove and Relocate Fiber Optics Conduit	284	LF	\$ 20.00	\$ 5,680.00	\$ 70.00	\$ 19,880.00	\$ 29.00	\$ 8,236.00	\$ 200.00	\$ 56,800.00	\$ 215.00	\$ 61,060.00
627.01	Channel Identifier Sign	1	EA	\$ 100.00	\$ 100.00	\$ 250.00	\$ 250.00	\$ 145.00	\$ 145.00	\$ 200.00	\$ 200.00	\$ 500.00	\$ 500.00
627.02	Warning Sign	5	Ea	\$ 170.00	\$ 850.00	\$ 300.00	\$ 1,500.00	\$ 170.00	\$ 850.00	\$ 200.00	\$ 1,000.00	\$ 750.00	\$ 3,750.00
629.01	Relocate 6-inch Waterline	66	LF	\$ 125.00	\$ 8,250.00	\$ 310.00	\$ 20,460.00	\$ 210.00	\$ 13,860.00	\$ 150.00	\$ 9,900.00	\$ 350.00	\$ 23,100.00
629.02	Relocate 8-inch Waterline	56	LF	\$ 3,300.00	\$ 184,800.00	\$ 370.00	\$ 20,720.00	\$ 430.00	\$ 24,080.00	\$ 175.00	\$ 9,800.00	\$ 400.00	\$ 22,400.00
629.03	Relocate 12-inch Waterline	43	LF	\$ 400.00	\$ 17,200.00	\$ 570.00	\$ 24,510.00	\$ 480.00	\$ 20,640.00	\$ 200.00	\$ 8,600.00	\$ 450.00	\$ 19,350.00
629.04	Relocate Fire Hydrant	3	EA	\$ 5,500.00	\$ 16,500.00	\$ 5,100.00	\$ 15,300.00	\$ 2,805.00	\$ 8,415.00	\$ 500.00	\$ 1,500.00	\$ 7,500.00	\$ 22,500.00
629.05	18-inch Steel Sleeve at Sta. 66+43	37	LF	\$ 150.00	\$ 5,550.00	\$ 115.00	\$ 4,255.00	\$ 130.00	\$ 4,810.00	\$ 275.00	\$ 10,175.00	\$ 500.00	\$ 18,500.00
629.06	30-inch Steel Sleeve at Sta 90+30	60	LF	\$ 250.00	\$ 15,000.00	\$ 250.00	\$ 15,000.00	\$ 280.00	\$ 16,800.00	\$ 300.00	\$ 18,000.00	\$ 620.00	\$ 37,200.00
629.07	Bore and Jack 18-inch Steel Sleeve - 8-inch Waterline Sta. 109+56	64	LF	\$ 900.00	\$ 57,600.00	\$ 1,440.00	\$ 92,160.00	\$ 980.00	\$ 62,720.00	\$ 400.00	\$ 25,600.00	\$ 1,600.00	\$ 102,400.00
629.08	Verify Existence of 18-inch Steel Sleeve - 8-inch Waterline Sta. 50+98	1	LS	\$ 3,500.00	\$ 3,500.00	\$ 1,000.00	\$ 1,000.00	\$ 4,580.00	\$ 4,580.00	\$ 250.00	\$ 250.00	\$ 30,000.00	\$ 30,000.00
629.09	Verify Existence of 24-inch Steel Sleeve - 12-inch Waterline Sta. 36+12	1	LS	\$ 3,500.00	\$ 3,500.00	\$ 1,000.00	\$ 1,000.00	\$ 4,580.00	\$ 4,580.00	\$ 250.00	\$ 250.00	\$ 30,000.00	\$ 30,000.00
629.10	Verify Existence of 24-inch Steel Sleeve - 12-inch Waterline Sta. 103+35	1	LS	\$ 3,500.00	\$ 3,500.00	\$ 1,000.00	\$ 1,000.00	\$ 5,140.00	\$ 5,140.00	\$ 250.00	\$ 250.00	\$ 30,000.00	\$ 30,000.00
629.11	18-inch Steel Sleeve - 8-inch Waterline Sta. 50+98	36	LF	\$ 400.00	\$ 14,400.00	\$ 260.00	\$ 9,360.00	\$ 730.00	\$ 26,280.00	\$ 150.00	\$ 5,400.00	\$ 750.00	\$ 27,000.00
629.12	24-inch Steel Sleeve - 12-inch Water line Sta. 36+12	104	LF	\$ 250.00	\$ 26,000.00	\$ 10.00	\$ 1,040.00	\$ 398.00	\$ 41,392.00	\$ 200.00	\$ 20,800.00	\$ 800.00	\$ 83,200.00
629.13	24-inch Steel Sleeve - 12-inch Waterline Sta. 103+35	78	LF	\$ 200.00	\$ 15,600.00	\$ 10.00	\$ 780.00	\$ 922.00	\$ 71,916.00	\$ 200.00	\$ 15,600.00	\$ 800.00	\$ 62,400.00
630.01	Extend 12-inch PVC Sanitary Sewer Pipe	140	LF	\$ 100.00	\$ 14,000.00	\$ 290.00	\$ 40,600.00	\$ 226.00	\$ 31,640.00	\$ 200.00	\$ 28,000.00	\$ 350.00	\$ 49,000.00

BID ABSTRACT
CITY OF NORTH LAS VEGAS
CENTENNIAL PARKWAY CHANNEL EAST
BID NO. 1304 - LABOR COMMISSION NO. PWP CL-2008-188
BID DATE: April 3, 2008

				ENGINEER'S ESTIMATE		LAS VEGAS PAVING CORPORATION		CONTRI CONSTRUCTION COMPANY		ROAD & HIGHWAY BUILDERS, LLC.		DON KELLY CONSTRUCTION, INC.	
ITEM	DESCRIPTION	QTY	UNIT	UNIT PRICE	TOTAL PRICE	UNIT PRICE	TOTAL PRICE	UNIT PRICE	TOTAL PRICE	UNIT PRICE	TOTAL PRICE	UNIT PRICE	TOTAL PRICE
630.02	18-inch Steel Sleeve - 8-inch Sanitary Sewer Sta. 50+86	36	LF	\$ 400.00	\$ 14,400.00	\$ 272.00	\$ 9,792.00	\$ 560.00	\$ 20,160.00	\$ 275.00	\$ 9,900.00	\$ 750.00	\$ 27,000.00
630.03	18-inch Steel Sleeve - 8-inch Sanitary Sewer Sta. 114+48	64	LF	\$ 300.00	\$ 19,200.00	\$ 280.00	\$ 17,920.00	\$ 410.00	\$ 26,240.00	\$ 275.00	\$ 17,600.00	\$ 750.00	\$ 48,000.00
630.04	20-inch Steel Sleeve - 10-inch Sanitary Sewer Sta. 116+49	64	LF	\$ 300.00	\$ 19,200.00	\$ 315.00	\$ 20,160.00	\$ 465.00	\$ 29,760.00	\$ 300.00	\$ 19,200.00	\$ 775.00	\$ 49,600.00
630.05	Bore and Jack 20-inch Steel Sleeve - 10-inch Sanitary Sewer Sta. 103+16	64	LF	\$ 300.00	\$ 19,200.00	\$ 1,450.00	\$ 92,800.00	\$ 1,075.00	\$ 68,800.00	\$ 400.00	\$ 25,600.00	\$ 1,700.00	\$ 108,800.00
630.06	Remove and Dispose of 12-inch Sanitary Sewer	39	LF	\$ 500.00	\$ 19,500.00	\$ 20.00	\$ 780.00	\$ 14.00	\$ 546.00	\$ 100.00	\$ 3,900.00	\$ 336.00	\$ 13,104.00
630.07	Remove and Dispose of Sanitary Sewer Manhole	1	EA	\$ 1,600.00	\$ 1,600.00	\$ 1,000.00	\$ 1,000.00	\$ 530.00	\$ 530.00	\$ 500.00	\$ 500.00	\$ 12,000.00	\$ 12,000.00
630.08	Sanitary Sewer Manhole	2	EA	\$ 5,000.00	\$ 10,000.00	\$ 2,600.00	\$ 5,200.00	\$ 8,135.00	\$ 16,270.00	\$ 4,000.00	\$ 8,000.00	\$ 12,000.00	\$ 24,000.00
637.01	Dust Control	1	LS	\$ 47,000.00	\$ 47,000.00	\$ 44,000.00	\$ 44,000.00	\$ 65,000.00	\$ 65,000.00	\$ 2,500.00	\$ 2,500.00	\$ 50,000.00	\$ 50,000.00
637.02	Dust Pallative	3	AC	\$ 1,000.00	\$ 3,000.00	\$ 1,650.00	\$ 4,950.00	\$ 810.00	\$ 2,430.00	\$ 3,000.00	\$ 9,000.00	\$ 1,500.00	\$ 4,500.00
TOTAL BASE BID					\$ 7,156,985.00		\$ 5,842,304.00		\$ 8,294,930.00		\$ 11,171,308.00		\$ 8,975,122.00
ADDITIVE/DEDUCTIVE													
212.02	Modify Landscaping and Irrigation System - Centennial 5 Retail Center	1	LS	\$ 18,000.00	\$ 18,000.00	\$ 23,000.00	\$ 23,000.00	\$ 93,280.00	\$ 93,280.00	\$ 28,501.00	\$ 28,501.00	\$ 255,000.00	\$ 255,000.00
613.06	Concrete Sidewalk - Centennial 5 Retail Center	5,160	SF	\$ 4.00	\$ 20,640.00	\$ 8.00	\$ 41,280.00	\$ 5.60	\$ 28,896.00	\$ 4.84	\$ 24,974.40	\$ 7.00	\$ 36,120.00
TOTAL ADDITIVE/DEDUCTIVE					\$ 38,640.00		\$ 64,280.00		\$ 122,176.00		\$ 53,475.40		\$ 291,120.00
ADDITIVE ALTERNATE A (PRECAST)													
509.01A	8-ft by 6-ft Precast RCB Storm Drain	77	LF	\$ 950.00	\$ 73,150.00	\$ 1,085.00	\$ 83,545.00	\$ 2,230.00	\$ 171,710.00	\$ 1,000.00	\$ 77,000.00	\$ -	\$ -
509.02A	14-ft by 6-ft Precast RCB Storm Drain	1,319	LF	\$ 1,050.00	\$ 1,384,950.00	\$ 1,150.00	\$ 1,516,850.00	\$ 1,200.00	\$ 1,582,800.00	\$ 900.00	\$ 1,187,100.00	\$ -	\$ -
509.03A	15-ft by 6-ft Precast RCB Storm Drain	1,327	LF	\$ 1,150.00	\$ 1,526,050.00	\$ 1,160.00	\$ 1,539,320.00	\$ 1,030.00	\$ 1,366,810.00	\$ 950.00	\$ 1,260,650.00	\$ -	\$ -
509.04A	15-ft by 7-ft Precast RCB Storm Drain	1,710	LF	\$ 1,200.00	\$ 2,052,000.00	\$ 1,190.00	\$ 2,034,900.00	\$ 1,480.00	\$ 2,530,800.00	\$ 1,000.00	\$ 1,710,000.00	\$ -	\$ -
509.05A	Double 15-ft by 6-ft Precast RCB Storm Drain	88	LF	\$ 2,000.00	\$ 176,000.00	\$ 2,160.00	\$ 190,080.00	\$ 1,980.00	\$ 174,240.00	\$ 1,700.00	\$ 149,600.00	\$ -	\$ -
509.06A	Double 20-ft by 6-ft Precast RCB Storm Drain	3,341	LF	\$ 2,500.00	\$ 8,352,500.00	\$ 2,700.00	\$ 9,020,700.00	\$ 2,696.00	\$ 9,007,336.00	\$ 2,600.00	\$ 8,686,600.00	\$ -	\$ -
TOTAL ADDITIVE ALTERNATE A					\$ 13,564,650.00		\$ 14,385,395.00		\$ 14,833,696.00		\$ 13,070,950.00		\$ -
ADDITIVE ALTERNATE B (CAST-IN-PLACE)													
502.01B	8-ft by 6-ft Precast RCB Storm Drain	77	LF	\$ 950.00	\$ 73,150.00	\$ -	\$ -	\$ -	\$ -	\$ -	\$ -	\$ 1,250.00	\$ 96,250.00
502.02B	14-ft by 6-ft Cast-in-Place RCB Storm Drain	1,319	LF	\$ 1,050.00	\$ 1,384,950.00	\$ -	\$ -	\$ -	\$ -	\$ -	\$ -	\$ 1,230.00	\$ 1,622,370.00
502.03B	15-ft by 6-ft Cast-in-Place RCB Storm Drain	1,327	LF	\$ 1,150.00	\$ 1,526,050.00	\$ -	\$ -	\$ -	\$ -	\$ -	\$ -	\$ 1,115.00	\$ 1,479,605.00
502.04B	15-ft by 7-ft Cast-in-Place RCB Storm Drain	1,710	LF	\$ 1,200.00	\$ 2,052,000.00	\$ -	\$ -	\$ -	\$ -	\$ -	\$ -	\$ 1,230.00	\$ 2,103,300.00
502.05B	Double 15-ft by 6-ft Cast-in-Place RCB Storm Drain	88	LF	\$ 2,000.00	\$ 176,000.00	\$ -	\$ -	\$ -	\$ -	\$ -	\$ -	\$ 3,045.00	\$ 267,960.00
502.06B	Double 20-ft by 6-ft Cast-in-Place RCB Storm Drain	3,341	LF	\$ 2,500.00	\$ 8,352,500.00	\$ -	\$ -	\$ -	\$ -	\$ -	\$ -	\$ 2,960.00	\$ 9,889,360.00
TOTAL ADDITIVE ALTERNATE B					\$ 13,564,650.00		\$ -		\$ -		\$ -		\$ 15,458,845.00
TOTAL BID INCLUDING ALTERNATE A					\$ 20,721,635.00		\$ 20,227,699.00		\$ 23,128,626.00		\$ 24,242,258.00		
TOTAL BID INCLUDING ALTERNATE B					\$ 20,721,635.00								\$ 24,433,967.00

BID ABSTRACT
CITY OF NORTH LAS VEGAS
CENTENNIAL PARKWAY CHANNEL EAST
BID NO. 1304 - LABOR COMMISSION NO. PWP CL-2008-188
BID DATE: April 3, 2008

				ENGINEER'S ESTIMATE		LAS VEGAS PAVING CORPORATION		CONTRI CONSTRUCTION COMPANY		ROAD & HIGHWAY BUILDERS, LLC.		DON KELLY CONSTRUCTION, INC.	
ITEM	DESCRIPTION	QTY	UNIT	UNIT PRICE	TOTAL PRICE	UNIT PRICE	TOTAL PRICE	UNIT PRICE	TOTAL PRICE	UNIT PRICE	TOTAL PRICE	UNIT PRICE	TOTAL PRICE
Subcontractors:				Concrete Work				Stewart & Sundell		Stewart & Sundell		Gunderson & Stanley Inc.	
				Steel Fabrication & Erection				Pacific Coast Steel					
				Landscape				Valley Crest				Rey Burne Landscape Co.	
				Traffic Control									
				Electrical				Las Vegas Electric		Sequoia Electric		Sequoia Electric, Inc.	
				Manholes				Olson Precast					
				Drop Inlets									
				Signage						Nehr & Sons			
				Fencing						Tiberti Company			
Suppliers:				Reinforced Concrete Pipe		Rinker Materials		Rinker Materials				Rinker	
				Reinforced Concrete Box		Rinker Materials		Rinker Materials					
				Type II Aggregate Base		Self		Las Vegas Paving				Impact	
				Portland Cement Concrete		Cemex Inc.		Service Rock				Redi Mix Inc.	
				Sewer and Water Pipes		HD Supply		Ferguson				Ferguson	

Glenda Washington
Prepared By

Kewie Ramsey
Checked By