

A.P.N. 123-30-701-001

OWNER: KB Home Las Vegas Inc, a Nevada corporation

EXHIBIT A

TRI-CORE SURVEYING, LLC
6753 WEST CHARLESTON BLVD.
LAS VEGAS, NV 89146

File: 08023.0013\lgl_vac PUE Tropical.doc

By: RF

Page 1 of 4

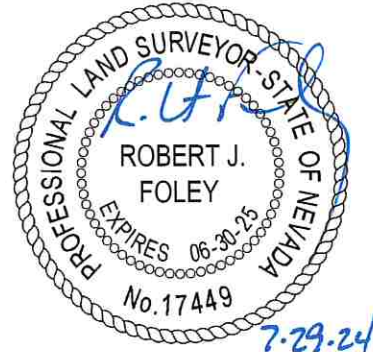

EXPLANATION

THIS LEGAL DESCRIPTION DESCRIBES A PARCEL OF LAND GENERALLY LOCATED SOUTH OF TROPICAL PARKWAY AND WEST OF N. LAMB BOULEVARD FOR PUBLIC UTILITY EASEMENT VACATION PURPOSES.

LEGAL DESCRIPTION

A PORTION OF THAT PUBLIC UTILITY EASEMENT (P.U.E) GRANTED TO CITY OF NORTH LAS VEGAS BY A PARCEL MAP RECORDED MAY 20, 2004 IN FILE 107, PAGE 38 OF PARCEL MAPS CLARK COUNTY OFFICIAL RECORDS. SITUATE IN THE SOUTHEAST QUARTER (SE 1/4) OF SECTION 30, TOWNSHIP 19 SOUTH, RANGE 62 EAST, M.D.M., CITY OF NORTH LAS VEGAS, CLARK COUNTY, NEVADA DESCRIBED AS FOLLOWS:

COMMENCING AT THE NORTHEAST CORNER OF SAID SOUTHEAST QUARTER (SE 1/4) OF SECTION 30; THENCE SOUTH 89°05'00" WEST ALONG THE NORTH LINE OF SAID SOUTHEAST QUARTER (SE 1/4) A DISTANCE OF 166.34 FEET; THENCE DEPARTING SAID NORTH LINE SOUTH 00° 55'00" EAST, 65.00 FEET TO THE SOUTH RIGHT-OF-WAY LINE OF TROPICAL PARKWAY DEDICATED PER INSTRUMENT NO. 20040520:02460 CLARK COUNTY OFFICIAL RECORDS BEING **THE POINT OF BEGINNING**;

THENCE DEPARTING SAID SOUTH RIGHT-OF-WAY LINE SOUTH 00°55'00" EAST, 5.00 FEET; THENCE SOUTH 89°05'00" WEST, 93.39 FEET TO THE BEGINNING OF A TANGENT CURVE CONCAVE NORTHEASTERLY HAVING A RADIUS OF 110.00 FEET; THENCE NORTHWESTERLY ALONG THE ARC OF SAID CURVE, 34.93 FEET THROUGH A CENTRAL ANGLE OF 18° 11'42" TO THE BEGINNING OF A REVERSE CURVE CONCAVE SOUTHWESTERLY HAVING A RADIUS OF 90.00 FEET TO WHICH A RADIAL LINE BEARS NORTH 17°16'42" EAST; THENCE NORTHWESTERLY ALONG THE ARC OF SAID CURVE, 28.58 FEET THROUGH A CENTRAL ANGLE OF 18°11'42"; THENCE SOUTH 89°05'00" WEST, 57.87 FEET; THENCE NORTH 89°38'37" WEST, 225.06 FEET; THENCE NORTH 00°16'49" WEST, 5.00 FEET TO THE SOUTH RIGHT-OF-WAY LINE OF SAID TROPICAL PARKWAY; THENCE ALONG SAID SOUTH RIGHT-OF-WAY LINE THE FOLLOWING FIVE (5) COURSES: (1) SOUTH 89°38'37" EAST, 225.06 FEET; (2) NORTH 89°05'00" EAST, 57.81 FEET TO THE BEGINNING OF A TANGENT CURVE CONCAVE SOUTHWESTERLY HAVING A RADIUS OF 95.00 FEET; (3) SOUTHEASTERLY ALONG THE ARC OF SAID CURVE, 30.17 FEET THROUGH A CENTRAL ANGLE OF 18°11'42" TO THE BEGINNING OF A REVERSE CURVE CONCAVE NORTHEASTERLY HAVING A RADIUS OF 105.00 FEET TO WHICH A RADIAL LINE BEARS SOUTH 17°16'42" WEST; (4) SOUTHEASTERLY ALONG THE ARC OF SAID CURVE, 33.34 FEET THROUGH A CENTRAL ANGLE OF 18°11'42"; (5) NORTH 89°05'00" EAST, 93.39 FEET TO THE **POINT OF BEGINNING** AS SHOWN ON EXHIBIT B ATTACHED HERETO AND MADE A PART HEREOF.

CONTAINING 2,199 SQUARE FEET

A.P.N. 123-30-701-001

OWNER: KB Home Las Vegas Inc, a Nevada Corporation

Page 2 of 4

BASIS OF BEARINGS

NORTH 89°05'00" EAST BEING THE BEARING OF THE NORTH LINE OF THE SOUTHEAST QUARTER (SE 1/4) OF SECTION 30, TOWNSHIP 19 SOUTH, RANGE 62 EAST, M.D.M., CITY OF NORTH LAS VEGAS, CLARK COUNTY, NEVADA AS SHOWN BY MAP THEREOF ON FILE IN THE CLARK COUNTY RECORDER'S OFFICE IN FILE 107, PAGE 38 OF PARCEL MAPS.

END OF DESCRIPTION

APN: 123-30-701-001
 OWNER: KB Home Las Vegas Inc

LINE TABLE

LINE	BEARING	LENGTH
L1	S00°55'00"E	65.00'
L2	S00°55'00"E	5.00'
L3	S89°05'00"W	93.39'
L4	S89°05'00"W	57.87'
L5	N89°38'37"W	225.06'
L6	N00°16'49"W	5.00'
L7	S89°38'37"E	225.06'
L8	N89°05'00"E	57.81'
L9	N89°05'00"E	93.39'

CURVE TABLE

CURVE	DELTA	RADIUS	LENGTH	TANGENT
C1	18°11'42"	110.00'	34.93'	17.61'
C2	18°11'42"	90.00'	28.58'	14.41'
C3	18°11'42"	95.00'	30.17'	15.21'
C4	18°11'42"	105.00'	33.34'	16.81'

EXHIBIT B