

VICINITY MAP



Fig. 10. Comparison of the  $\alpha$  and  $\beta$  relaxation times of the polymer blends.

ARCHITECTURAL SITE PLAN

PROPOSED WOODSPRING SUITES HOTEL

I-15 &amp; LAND.

F-15 & LAND,  
 N. LAS VEGAS, NV.

ARCH SITE PLAN

101  
architecture

[illegible]

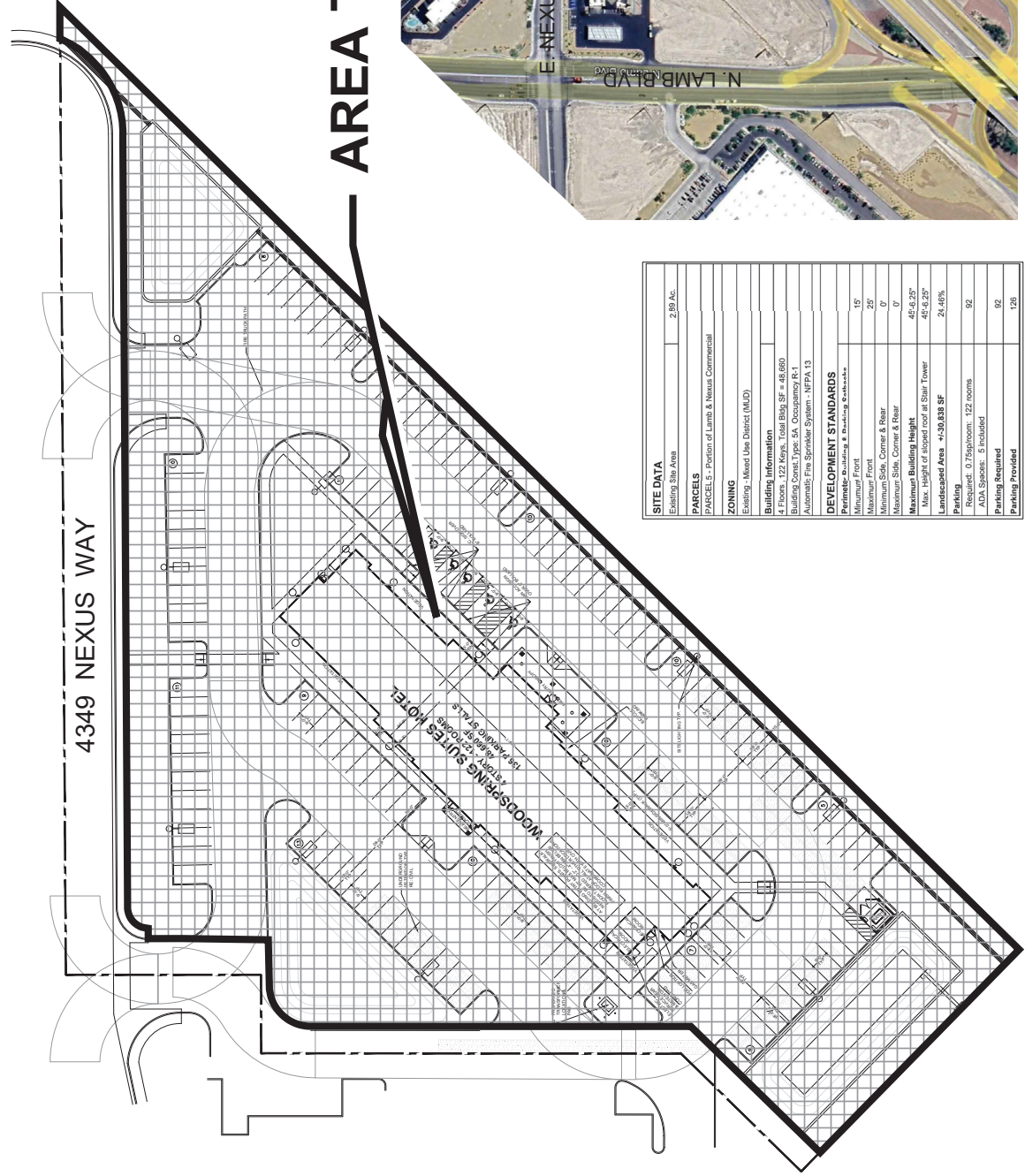

# SITE PLAN

## AREA TO BE VACATED

<b>SITE DATA</b>	Existing Site Area	2.88 Ac.
<b>PARCELS</b>	PARCEL 5 - Portion of Lamb & Nexus Commercial	
<b>ZONING</b>	Existing - Mixed Use District (MUD)	
<b>Building Information</b>	4 Floors, 122 Motel Units, SF = 48,880	
Building Code Type: SA, Occupancy R-1	Automatic Fire Sprinkler System - NFPA 13	
<b>DEVELOPMENT STANDARDS</b>	Perimeter Driveway & Driveway Gateways	
Minimum Front	15'	
Minimum Side, Corner & Rear	25'	
Minimum Side, Corner & Rear	0'	
<b>Maximum Building Height</b>	45'-6.25'	
Max. Height of Super Tower at Star Tower	45'-6.25'	
<b>Landscaped Area</b>	41,508.828 SF	24.46%
<b>Parking</b>	Required: 0 / 250/room: 122 rooms	92
ADA Spaces: 5 Included		92
<b>Parking Provided</b>		126

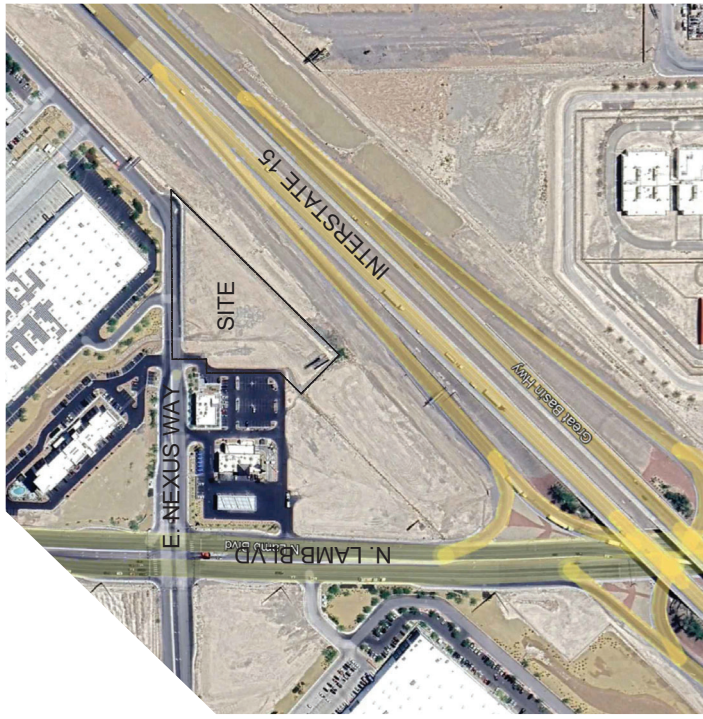

2 VICINITY MAP

1 ARCH SITE PLAN

AS-1

ARCHITECTURAL SITE PLAN  
PROPOSED WOODSPRING SUITES HOTEL  
1-15 & LAMB,  
N. LAS VEGAS, NV.

© 10/ ARCHITECTURE LLC. ALL RIGHTS RESERVED.  
NO PART OF THIS DOCUMENT MAY BE REPRODUCED OR TRANSMITTED IN ANY FORM OR BY ANY MEANS, ELECTRONIC OR MECHANICAL, WITHOUT PERMISSION IN WRITING FROM ARCHITECTURE LLC.  
THIS DOCUMENT IS THE PROPERTY OF ARCHITECTURE LLC. IT IS TO BE USED ONLY FOR THE PROJECT AND SITE SPECIFICALLY IDENTIFIED HEREIN. IT IS NOT TO BE USED FOR ANY OTHER PROJECT OR SITE WITHOUT THE WRITTEN PERMISSION OF ARCHITECTURE LLC.