

A.P.N. 123-28-511-002

OWNER: KW FUND VII-NORTH BELT ROAD, LP, a Delaware limited partnership

EXHIBIT A

TRI-CORE SURVEYING, LLC
6753 WEST CHARLESTON BLVD.
LAS VEGAS, NV 89146

File: 43223.0001\lgl_vac PUE

By: RF

Date: January 24, 2024

Page 1 of 2

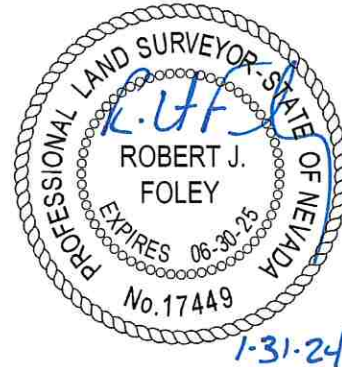

EXPLANATION

THIS LEGAL DESCRIPTION DESCRIBES A PARCEL OF LAND GENERALLY LOCATED SOUTH OF E. NORTH BELT ROAD AND EAST OF E. TROPICAL PARKWAY FOR THE VACATION OF A PUBLIC UTILITY EASEMENT (P.U.E.)

LEGAL DESCRIPTION

THAT CERTAIN EASEMENT FOR PUBLIC UTILITIES RESERVED BY ORDER OF VACATION **VAC-02-2020** RECORDED MARCH 1, 2021 AS INSTRUMENT No. 20210301-0001429 CLARK COUNTY OFFICIAL RECORDS DESCRIBED AS FOLLOWS:

THE EAST 30.00 FEET OF THE NORTHWEST QUARTER (NW 1/4) OF THE NORTHEAST QUARTER (NE 1/4) OF SECTION 28, TOWNSHIP 19 SOUTH, RANGE 62 EAST, M.D.M., CITY OF NORTH LAS VEGAS, CLARK COUNTY, NEVADA.

EXCEPTING THEREFROM THE NORTH 50.00 FEET OF SAID EAST 30.00 FEET;

FURTHER EXCEPTING THEREFROM ANY PORTION LYING SOUTH OF THE NORTH RIGHT-OF-WAY LINE OF I-15 AS SHOWN ON EXHIBIT B ATTACHED HERETO AND MADE A PART HEREOF.

APN 123-28-511-002

OWNER: KW FUND VII-NORTH BELT ROAD, LP, a Delaware limited partnership

EXHIBIT B

1/4
21
28

E 1/16
21
28

E NORTH BELT ROAD

PUBLIC R/W PER OR: 1146:1105693

30' P.U.E. RESERVE
BY VAC-02-2020
OR: 20210301: 01429

A PORTION OF
APN 123-28-511-002
MOAIC COMMERCE CENTER
BOOK 166, PAGE 33
OF PLATS

NW 1/4, NE 1/4

1-15
PUBLIC R/W
PER OR: 0409: 330131

532'

N 1/16
C
28

NE 1/16
28

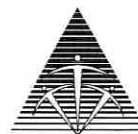

Tri-Core
SURVEYING

WWW.TRICORESURVEYING.COM