

RECORD OF SURVEY FOR THE ANNEXATION
TO THE CITY OF NORTH LAS VEGAS

A PORTION OF THE SOUTH HALF (S 1/2) OF THE SOUTHWEST QUARTER (SW 1/4) OF THE
NORTHWEST QUARTER (NW 1/4) OF SECTION 34, TOWNSHIP 19 SOUTH, RANGE 62 EAST,
M.D.M., CITY OF NORTH LAS VEGAS CLARK COUNTY, NEVADA

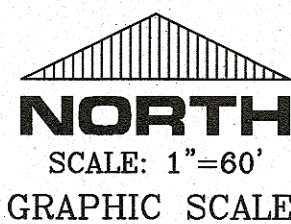

SURVEYOR'S CERTIFICATE

I, JAMES T. STOVALL, A PROFESSIONAL LAND SURVEYOR LICENSED IN THE STATE OF NEVADA AS AGENT FOR TANAY ENGINEERING, INC., DO HEREBY CERTIFY THAT:

- THIS PLAT REPRESENTS THE RESULTS OF A SURVEY CONDUCTED UNDER MY DIRECT SUPERVISION AT THE INSTANCE OF PROLOGIS-EXCHANGE NV 2002 LLC.
- THE LANDS SURVEYED LIE WITHIN THE SOUTH HALF (S 1/2) OF THE SOUTHWEST QUARTER (SW 1/4) OF THE NORTHWEST QUARTER (NW 1/4) OF SECTION 34, TOWNSHIP 19 SOUTH, RANGE 62 EAST, M.D.M., CITY OF NORTH LAS VEGAS, CLARK COUNTY, NEVADA, THE SURVEY WAS COMPLETED ON APRIL 2, 2024.
- THIS PLAT COMPLIES WITH THE APPLICABLE STATE STATUTES AND ANY LOCAL ORDINANCES IN EFFECT ON THE DATE THIS SURVEY WAS COMPLETED AND THE SURVEY CONDUCTED IN ACCORDANCE WITH CHAPTER 625 OF THE NEVADA ADMINISTRATIVE CODE.
- THE MONUMENTS DEPICTED ON THE PLAT ARE OF THE CHARACTER SHOWN, OCCUPY THE POSITIONS INDICATED AND ARE OF SUFFICIENT NUMBER AND DURABILITY.

JAMES T. STOVALL
PROFESSIONAL LAND SURVEYOR
NEVADA CERTIFICATE NO. 9992

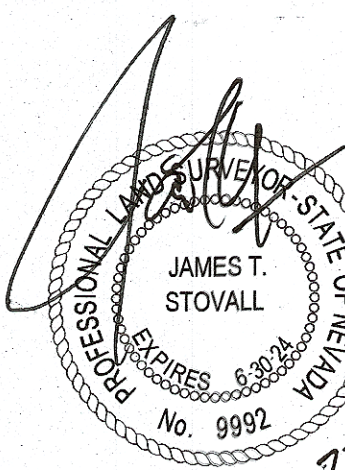

BASIS OF BEARINGS

NORTH 00°44'55" EAST, BEING THE WEST LINE OF THE SOUTHWEST QUARTER (SW 1/4) OF THE NORTHWEST QUARTER (NW 1/4) OF SECTION 34, TOWNSHIP 19 SOUTH, RANGE 62 EAST, M.D.M., CITY OF NORTH LAS VEGAS, CLARK COUNTY, NEVADA, AS SHOWN ON THAT CERTAIN SURVEY MAP, RECORDED IN FILE 169, PAGE 54, OFFICIAL RECORDS OF CLARK COUNTY, NEVADA

APPROVAL

APPROVED THIS _____ DAY OF _____, 202__.

PAMELA GOYNES-BROWN

ATTEST:

JACKIE RODGERS, CITY CLERK

COUNTY RECORDER'S NOTE

ANY SUBSEQUENT CHANGES TO THIS MAP SHOULD BE EXAMINED AND MAY BE DETERMINED BY REFERENCE TO THE COUNTY RECORDER'S CUMULATIVE MAP INDEX. N.R.S. 278.5695.

ANNEXATION NO. 176

ORDINANCE NO. 3206

RECORD OF SURVEY FOR THE ANNEXATION
TO THE CITY OF NORTH LAS VEGAS

A PORTION OF THE SOUTH HALF (S 1/2) OF THE SOUTHWEST
QUARTER (SW 1/4) OF THE NORTHWEST QUARTER (NW 1/4) OF
SECTION 34, TOWNSHIP 19 SOUTH, RANGE 62 EAST, M.D.M.,
CITY OF NORTH LAS VEGAS CLARK COUNTY, NEVADA

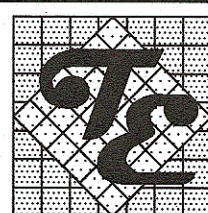

TANAY ENGINEERING
6030 S. JONES BOULEVARD
LAS VEGAS, NEVADA 89118
(702) 362-8844 FAX: (702) 362-5233

OFFICIAL RECORDS BOOK NO. _____

INSTRUMENT NO. _____
FILED AT THE REQUEST OF
TANAY ENGINEERING

DATE _____ AT _____
FILE _____ PAGE _____
OF SURVEYS

CLARK COUNTY, NEVADA RECORDS
DEBBIE CONWAY - RECORDER

FEE \$ _____ DEPUTY _____

LEGAL DESCRIPTION

BEING ALL OF THE PARCEL OF LAND LYING WITHIN THE SOUTHWEST QUARTER (SW 1/4) OF THE SOUTHWEST QUARTER (SW 1/4) OF THE NORTHWEST QUARTER (NW 1/4) AND THE WEST HALF (W 1/2) OF THE SOUTHEAST QUARTER (SE 1/4) OF THE SOUTHWEST QUARTER (SW 1/4) OF THE NORTHWEST QUARTER (NW 1/4) OF SECTION 34, TOWNSHIP 19 SOUTH, RANGE 62 EAST, M.D.M., CLARK COUNTY, NEVADA.

CONTAINS 15.96 ACRES, MORE OR LESS.

LEGEND

	ANNEXATION BOUNDARY LINE
	STREET CENTERLINE
	ADJOINING PARCEL LINE/RIGHT-OF-WAY
	LOT LINES
	CITY OF NORTH LAS VEGAS BOUNDARY LINE
	FOUND MONUMENT AS SHOWN AND DESCRIBED
	OFFICIAL RECORDS OF CLARK COUNTY, NEVADA
	ASSESSORS PARCEL NUMBER