

PROJECT TEAM

OWNER
COLUMBIA NEVADA CAREY INDUSTRIAL, LLC
ATTN: JACOB EMERY
102 N. LASALLE STREET, SUITE 2000
CHICAGO, IL 60602
PHONE: 312-345-4762
JEMERY@LPC.COM

DEVELOPER
LINCOLN PROPERTY COMPANY
ATTN: MICHAEL MORRICE
3131 EAST CAMELBACK ROAD, SUITE 318
PHOENIX, AZ 85018
PHONE: 602-412-8871
MMORRICE@LPC.COM

CIVIL ENGINEER
ACTUS
3383 E. WARM SPRINGS ROAD, SUITE 300
LAS VEGAS, NEVADA 89119
T: 702-586-0208
ATTN: DARRYL LATTIMORE, PE
DARRYL.LATTIMORE@ACTUS-NV.COM

UTILITY CONTACTS

POWER
NV ENERGY
ATTN: NEW DEVELOPMENT
7145 LINDELL ROAD
LAS VEGAS, NEVADA 89118

WATER
CITY OF NORTH LAS VEGAS
ATTN: UTILITIES DEPARTMENT
2250 LAS VEGAS BOULEVARD
NORTH LAS VEGAS, NV 89030
T: 702-633-1484

SEWER
CITY OF NORTH LAS VEGAS
ATTN: UTILITIES DEPARTMENT
2250 LAS VEGAS BOULEVARD
NORTH LAS VEGAS, NV 89030
T: 702-633-1484

GAS
SOUTHWEST GAS CORPORATION
ATTN: ENGINEERING SERVICES
6305 STATE STREET
NORTH LAS VEGAS, NV 89115

TELEPHONE
CENTURY LINK
6700 VA AGRESTI PARKWAY
LAS VEGAS, NEVADA 89119

DISPOSAL
REPUBLIC SERVICES, INC.
771 E. SHARPA AVE. P.O. BOX 98008
LAS VEGAS, NEVADA 89193-8008

CABLE
COX COMMUNICATIONS
1700 VEGAS DRIVE
LAS VEGAS, NEVADA 89106

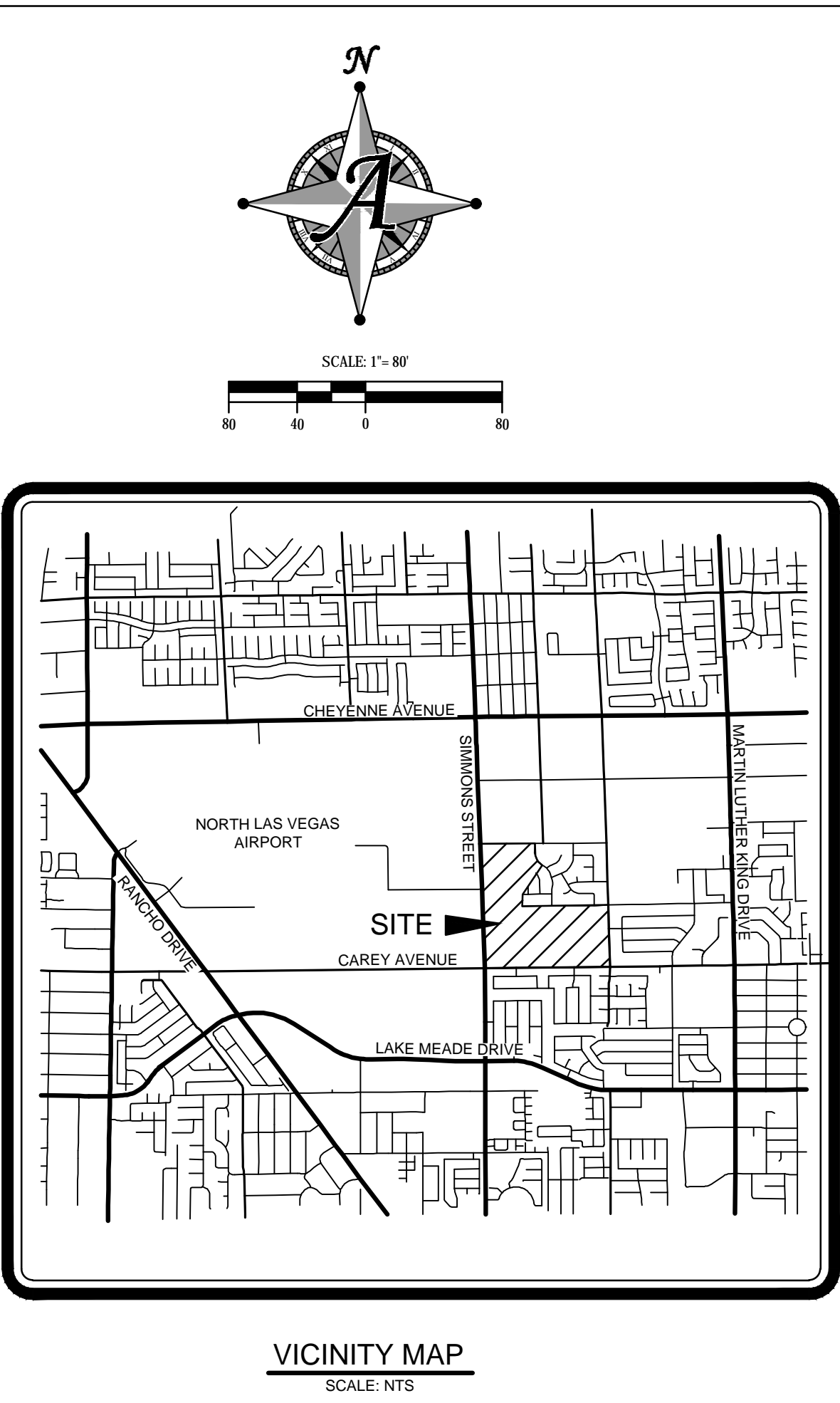

BASIS OF BEARINGS
SOUTH 02°11'43" EAST, BEING THE BEARING OF THE WEST LINE OF THE SOUTHWEST QUARTER (Q1/4) OF THE SOUTHEAST QUARTER (SE 1/4) OF SECTION 17, TOWNSHIP 20 SOUTH, RANGE 61 EAST, 4 D.M., CITY OF NORTH LAS VEGAS, CLARK COUNTY, NEVADA AS RECORDED IN FILE 63, PAGE 48 OF PLATS IN THE OFFICE OF THE CLARK COUNTY RECORDER'S.

BENCHMARK
CITY OF NORTH LAS VEGAS BENCHMARK NO. NLV0117C4
A RIVET AND 2" ROUND ALUMINUM DISK SET IN THE TOP OF CURB.
LOCATED APPROX. 70 FEET NORTH OF THE INTERSECTION NORTHWEST RETURN AT THE INTERSECTION OF EVANS AND SIMMONS.
ELEVATION: 2152.61 (FEET)
656.17 (METERS)
BASED ON NORTH AMERICAN VERTICAL DATUM OF 1988 (NAVD'88).

DISCLAIMER NOTE
THE UNDERGROUND UTILITIES AS SHOWN HEREON HAVE BEEN LOCATED FROM OBSERVED FIELD SURVEY EVIDENCE AND EXISTING DRAWINGS, INCLUDING BUT NOT LIMITED TO THE FOLLOWING: PLANS PROVIDED BY THE CLIENT, UTILITY COMPANIES, AND MUNICIPAL AGENCIES. THE SURVEYOR MAKES NO GUARANTEES THAT THE UNDERGROUND UTILITIES SHOWN COMPRISE ALL SUCH UTILITIES IN THE AREA, EITHER IN SERVICE OR ABANDONED. THE SURVEYOR FURTHER DOES NOT WARRANT THAT THE UNDERGROUND UTILITIES SHOWN ARE IN THE EXACT LOCATION INDICATED ALTHOUGH HE DOES CERTIFY THAT THEY ARE LOCATED AS ACCURATELY AS POSSIBLE FROM INFORMATION AVAILABLE. THE SURVEYOR HAS NOT PHYSICALLY LOCATED THE UNDERGROUND UTILITIES.

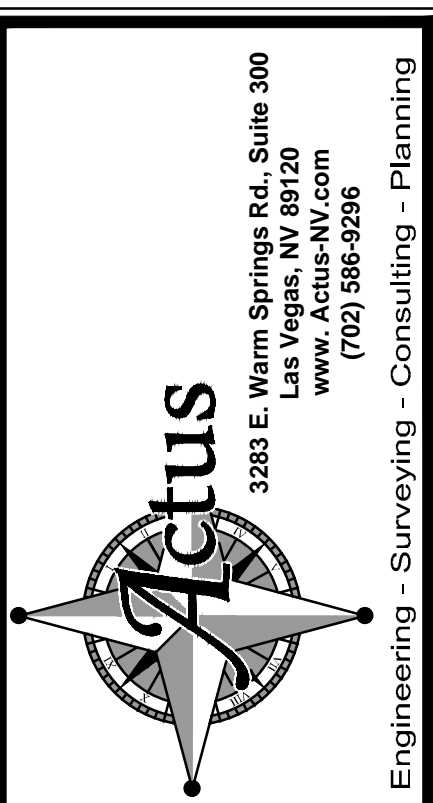

SITE PLAN
WINDSOR COMMERCE PARK
LINCOLN PROPERTY COMPANY
CITY OF NORTH LAS VEGAS

DATE	BY	DESCRIPTION

DATE: 7/3/2024
DRAWN: BP
DESIGNED: BP
CHECKED: DGL
PROJECT #: LPC012101
SHEET GROUP